

Appendix 12: Masterplan Study

ST JOHN OF GOD MURDOCH HOSPITAL **MASTERPLAN STUDY**

FEBRUARY 2023



1. SITE ANALYSIS

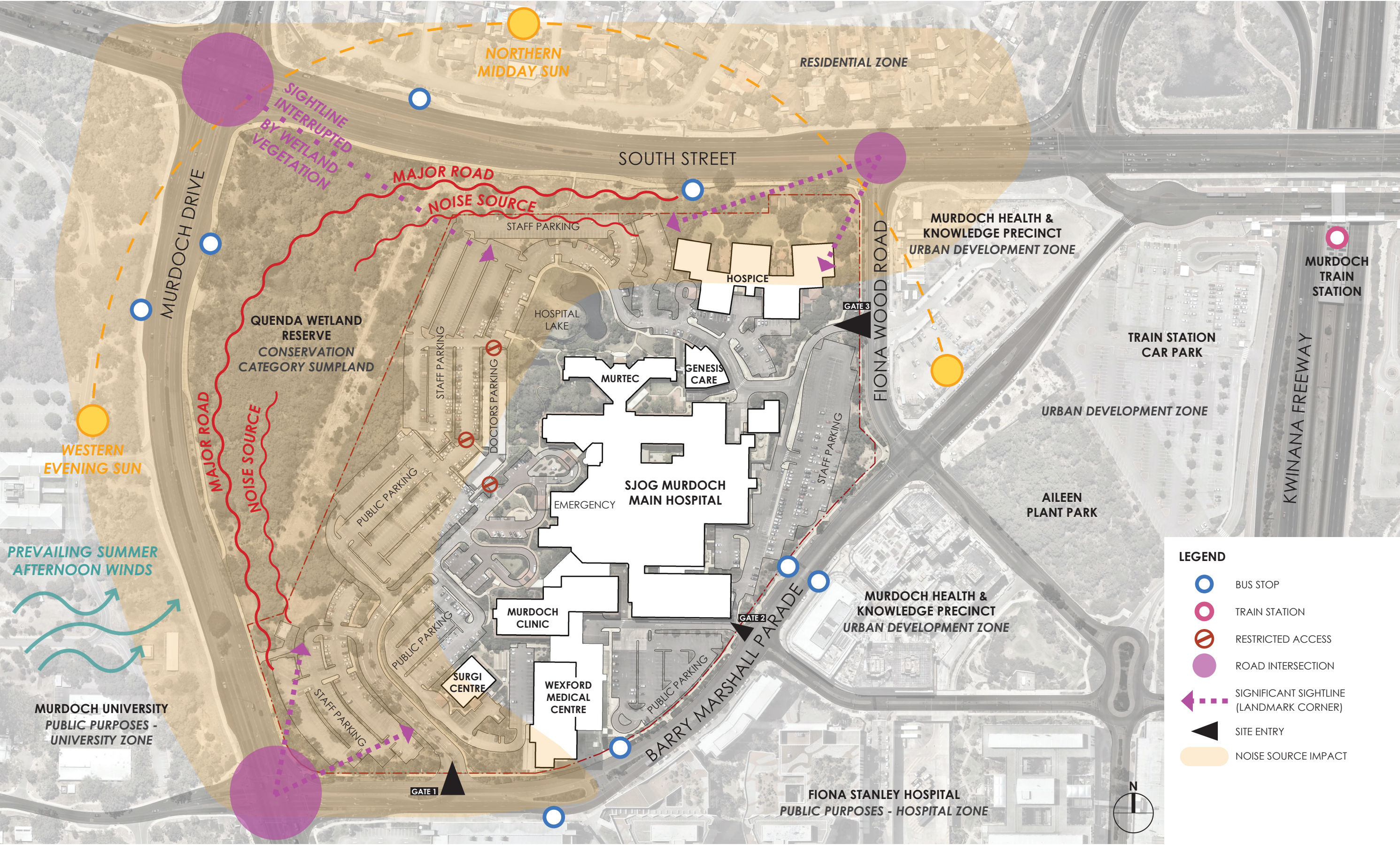

- LEGEND**
- BUS STOP
 - TRAIN STATION
 - RESTRICTED ACCESS
 - ROAD INTERSECTION
 - SIGNIFICANT SIGHTLINE (LANDMARK CORNER)
 - SITE ENTRY
 - NOISE SOURCE IMPACT

1.1 SITE VIEWS



A. MURDOCH DR / SOUTH ST INTERSECTION



B. VIEW FROM SOUTH ST



C. MURDOCH DR / BARRY MARSHALL PDE INTERSECTION



D. VIEW TOWARDS WETLANDS FROM MAIN HOSPITAL



E. HOSPITAL LAKE



F. VIEW ACROSS CAR PARK TOWARDS WETLANDS



G. VIEW TOWARDS SOUTH ST ADJACENT HOSPITAL LAKE

2. CAMPUS ZONING

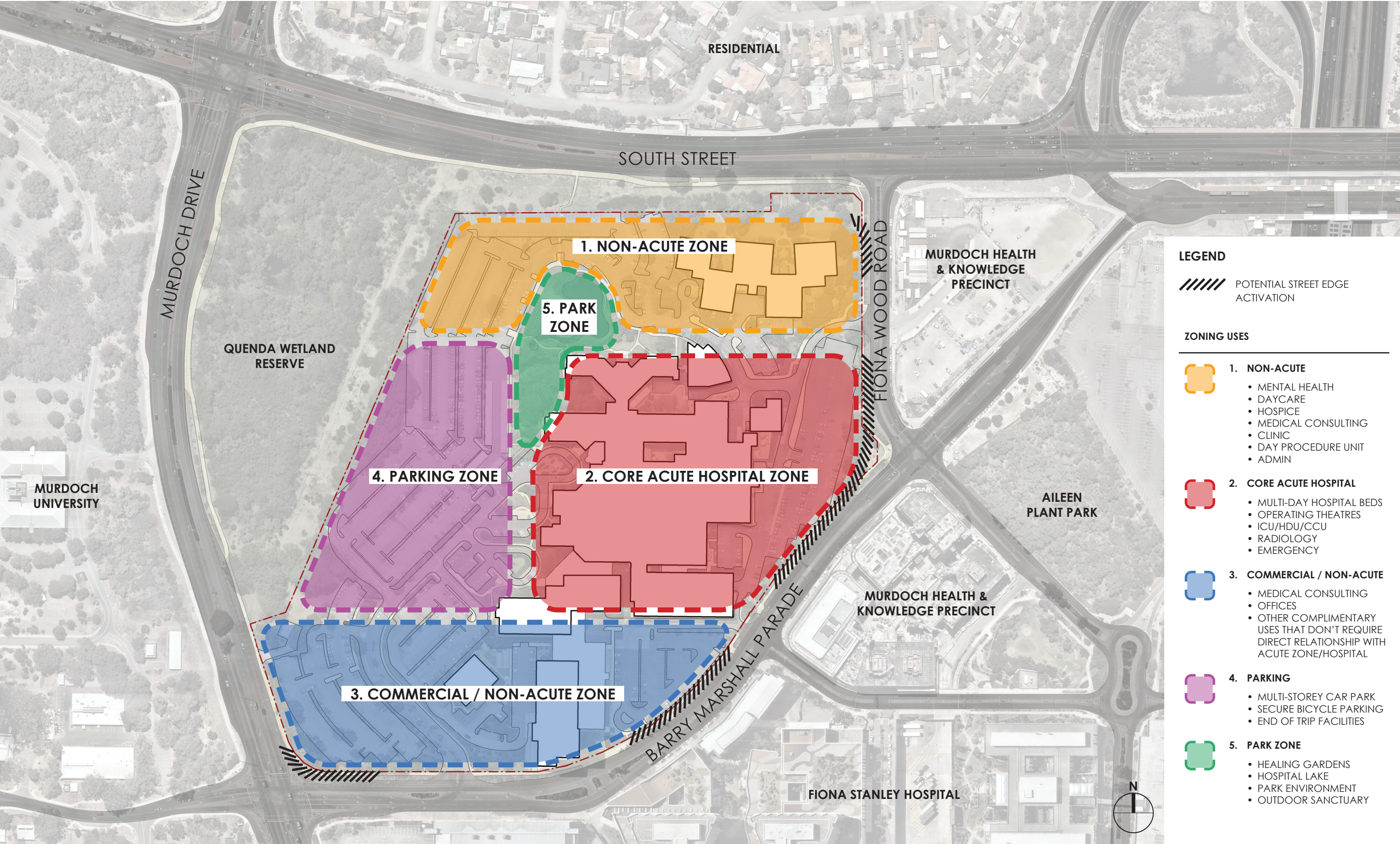

3. BUILT FORM

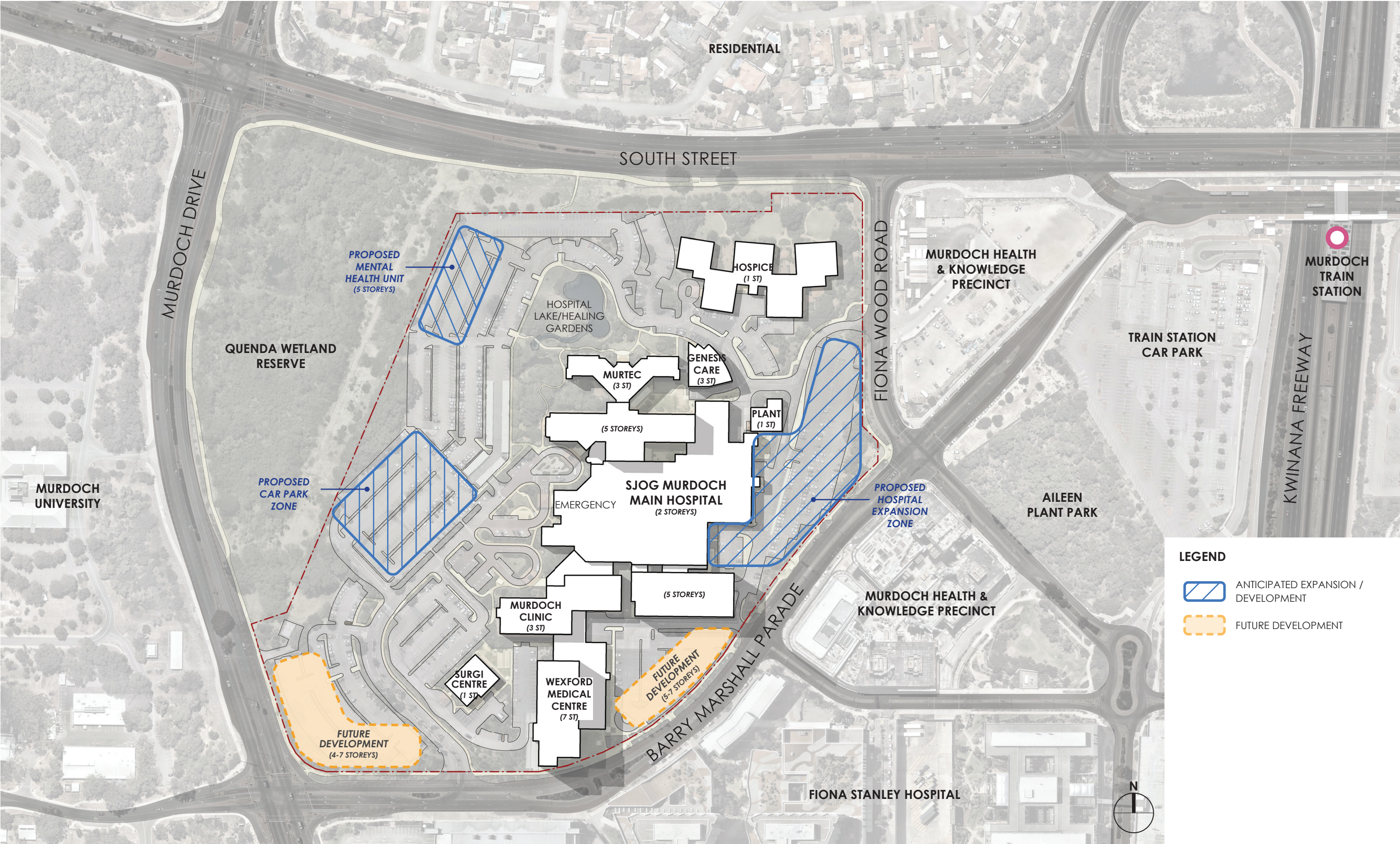

4. ACCESS & WAYFINDING

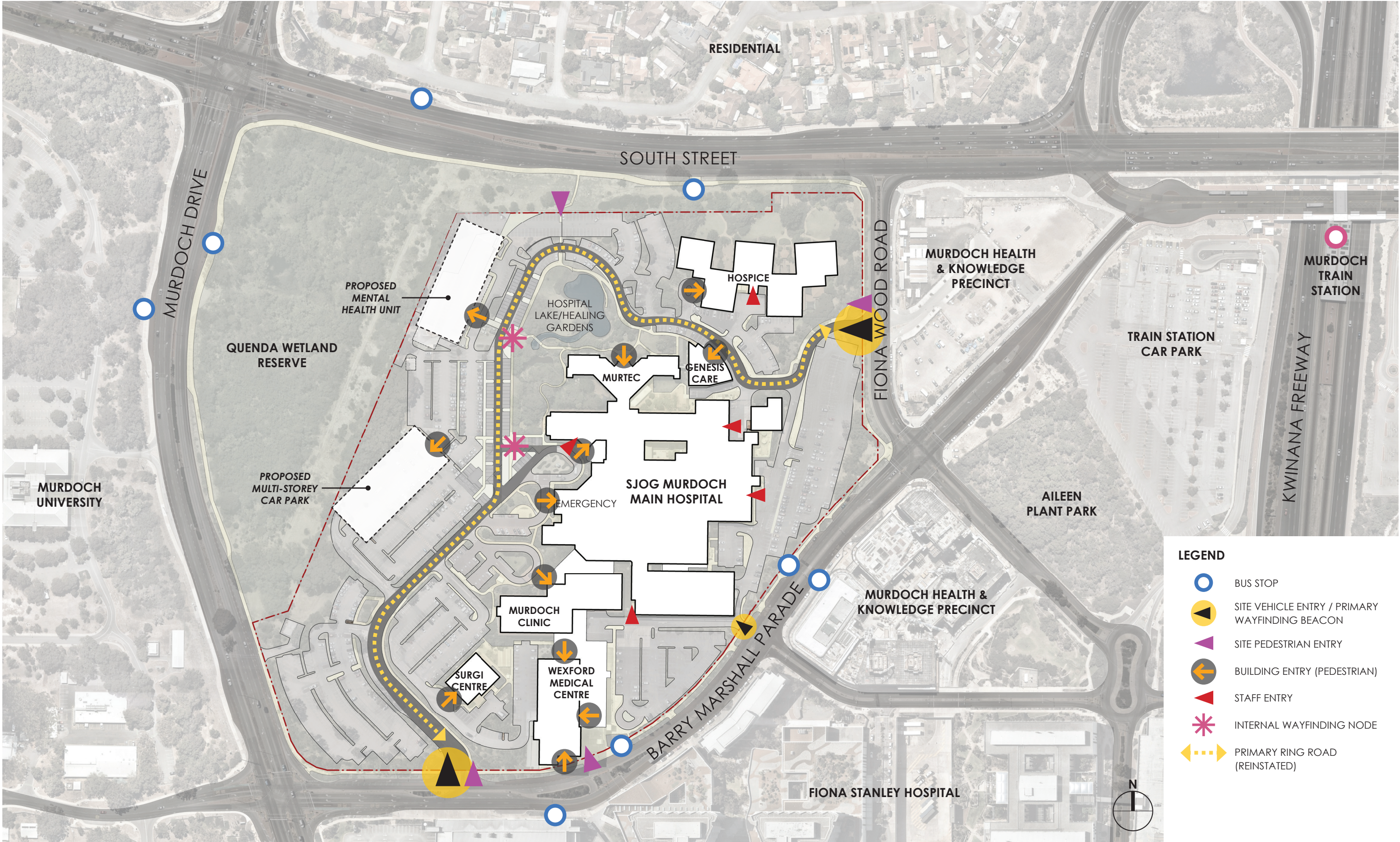

5. MOVEMENT/TRANSPORT

DEPARTMENT OF PLANNING, LANDS
AND HERITAGE
DATE: 24 Feb 2023 FILE: SDMU-052-23

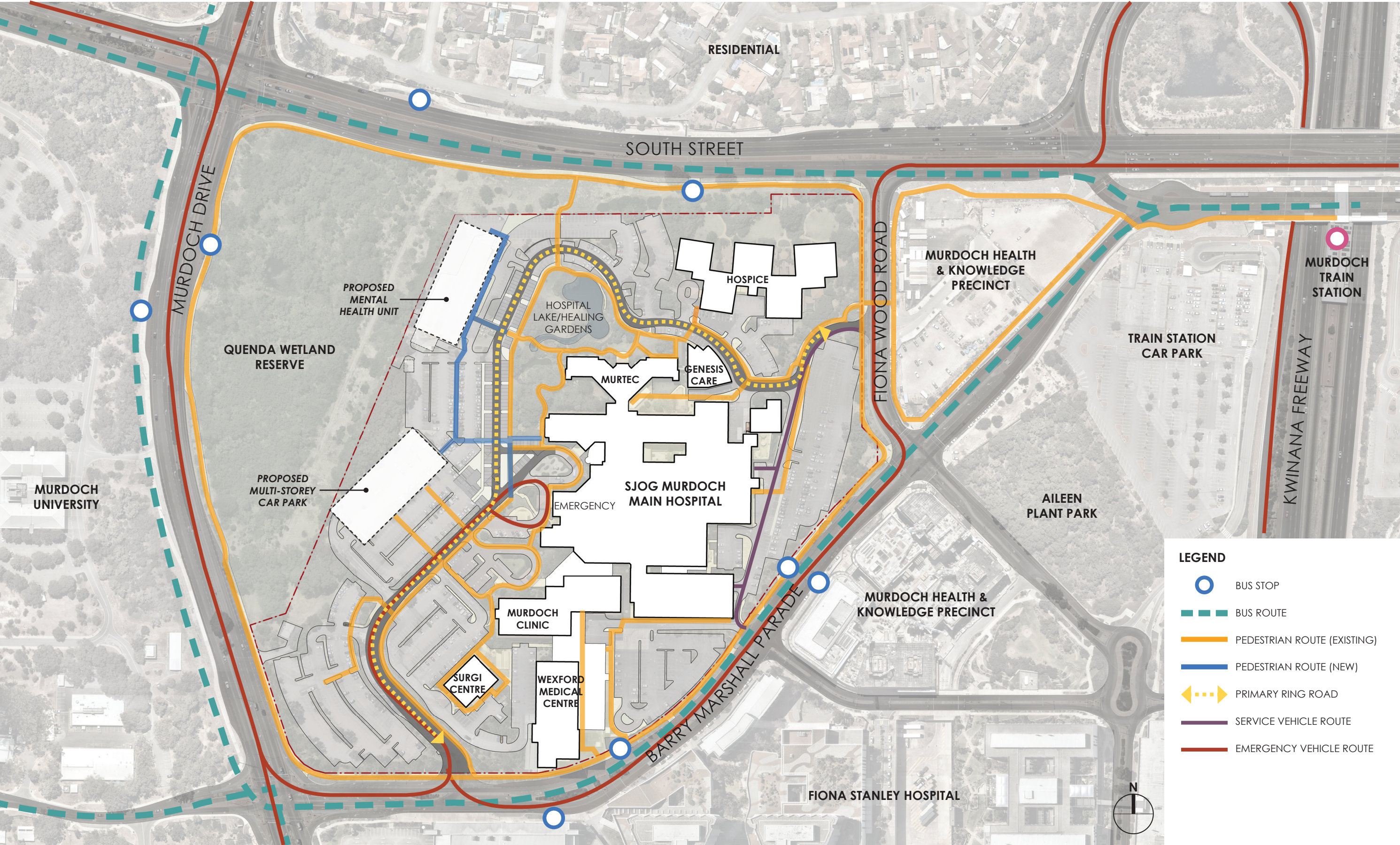

6. PEDESTRIAN CONNECTIVITY

DEPARTMENT OF PLANNING, LANDS
AND HERITAGE
DATE: 24 FEB 2023 FILE: SDMP-052-23

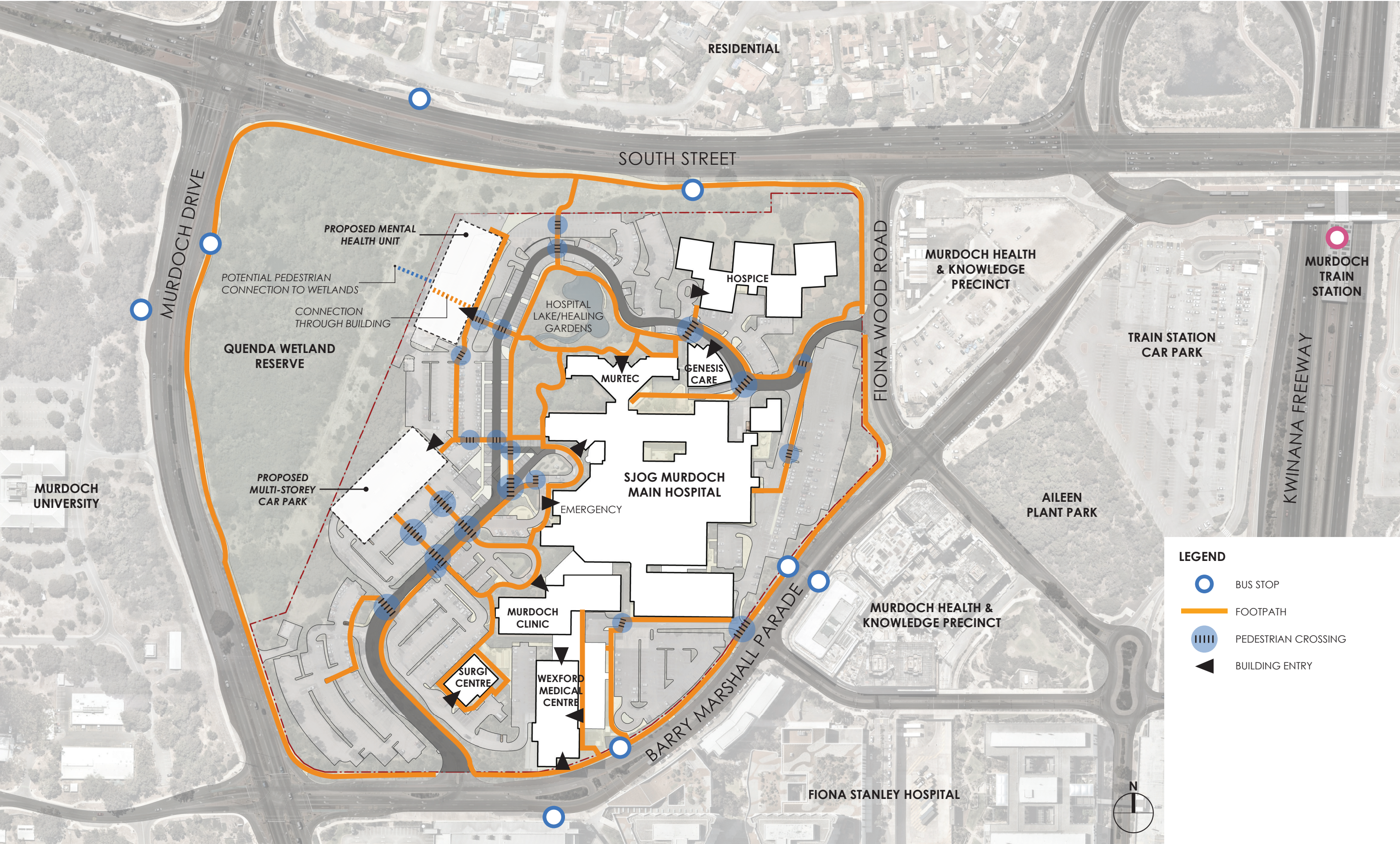

7. PARKING ZONING

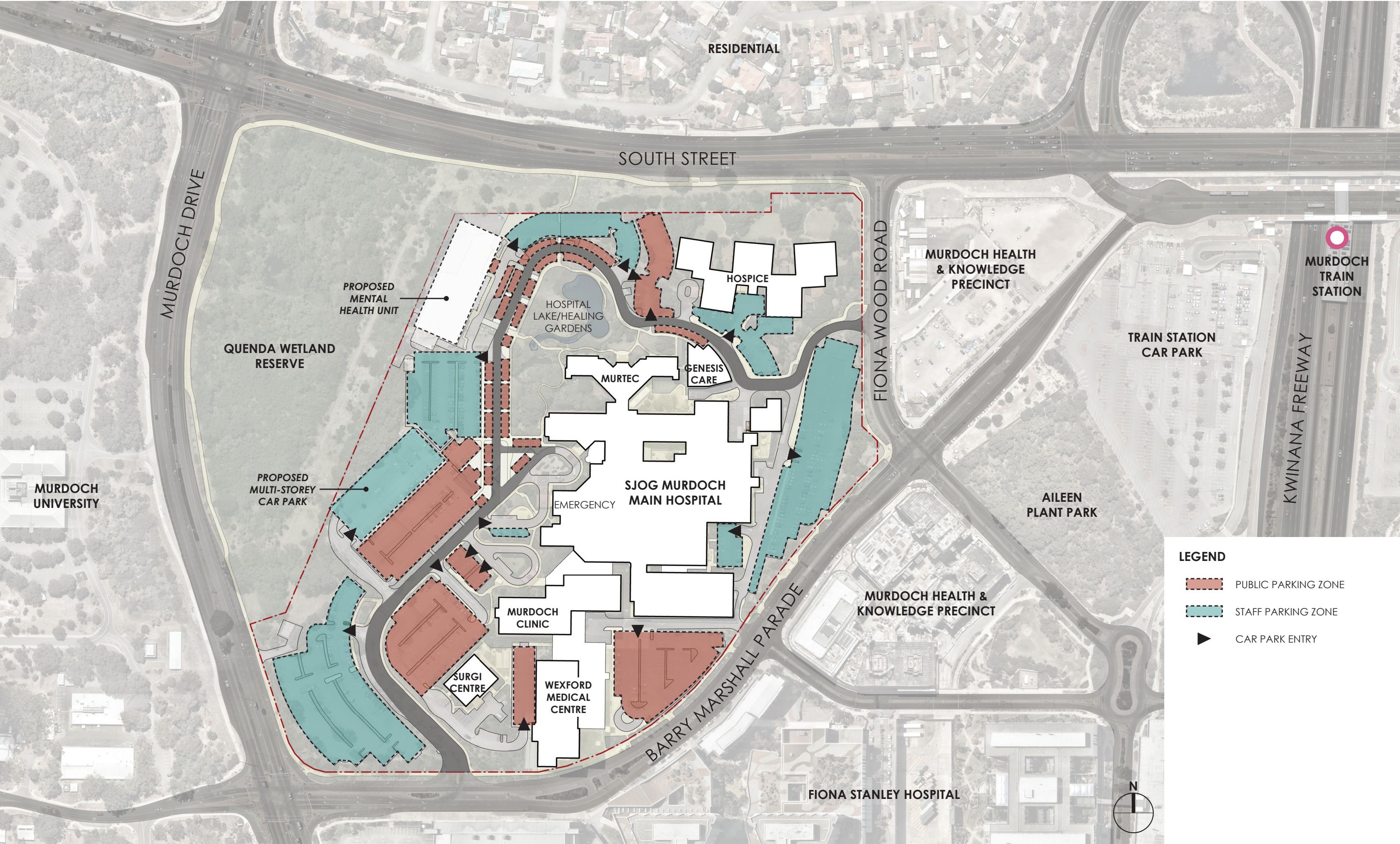

8. RING ROAD REACTIVATION

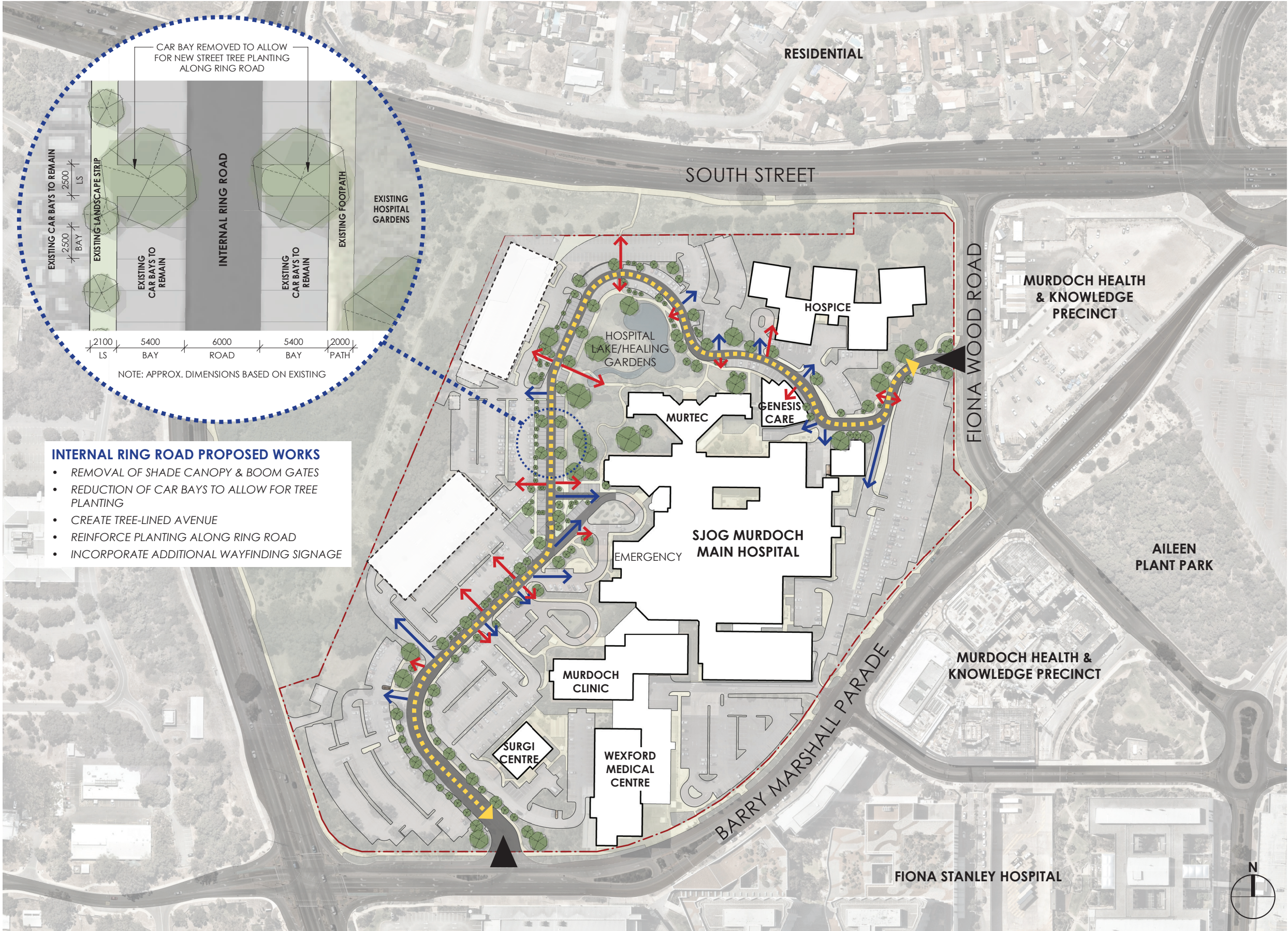

INTERNAL RING ROAD RE-ESTABLISHMENT PRINCIPLES

- PRIMARY WAYFINDING ELEMENT
- INTERNAL STREET
- CONNECTIVITY
- LEGIBILITY
- LANDSCAPED CONNECTOR
- ACTIVE LINK
- EASE OF USE
- CONTINUOUS PATH OF TRAVEL

