

**ATTACHMENT E – CONCEPTUAL PLAN FOR UPGRADE OF
ALMONDBURY/RISELEY/COOMERA INTERSECTION (BG&E)**

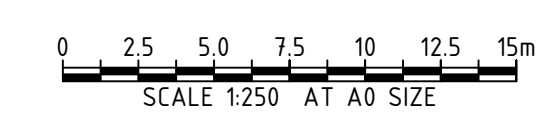
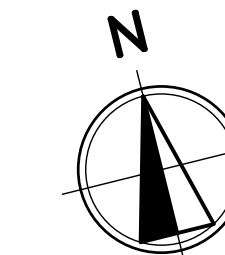

NOTES

1. ALL DIMENSIONS SHOWN ARE IN METRES UNLESS NOTED OTHERWISE.
2. READ IN CONJUNCTION WITH OTHER DRAWINGS.
3. CONTRACTOR SHALL CONFIRM THE LOCATIONS OF ALL EXISTING SERVICES PRIOR TO CONSTRUCTION. ANY SERVICES DISTURBED DURING CONSTRUCTION SHALL BE REINSTATED.
4. ALL KERBS TO BE SEMI-MOUNTABLE KERB (SMK) UNLESS NOTED OTHERWISE.
5. FOR PAVEMENT TYPE AND LOCATION REFER TO DRG No's BGC-73.5021 TO BGC-73.5032.
6. FOR PAVEMENT MARKING LINE TYPES, DETAILS AND LINE WIDTHS REFER TO MRWA STD DRG No. 9931-0198.
7. PIANO MARKINGS ON RAMPS TO BE INSTALLED AS PER AS1742.13 ROAD HUMPS MARKINGS.
8. PEDESTRIAN CROSSING MARKING TO BE IN ACCORDANCE WITH AS 1742.10.

LEGEND

- CADASTRAL
- EXISTING SURVEY
- EDGE OF GARDEN CITY BUILDING (REV G)
- BUILDING STAGE 1
- BUILDING STAGE 2
- BUILDING STAGE 3
- BUILDING STAGE 4
- BUILDING STAGE 5
- BUILDING STAGE 6
- BUILDING STAGE 7
- BUILDING STAGE TBC
- BROKEN SEPARATION LINE
- EDGE LINE
- UNBROKEN SINGLE BARRIER LINE
- CONTINUITY LINE
- BROKEN TURN LINE
- PATH SEPARATION LINE
- STOP LINE
- GIVE WAY LINE
- PEDESTRIAN GUIDE LINE
- PAVEMENT ARROWS
- CYCLIST PAVEMENT MARKING
- SINGLE SIGN POST
- EXISTING SIGN POST TO BE REMOVED

PROJECT NO.	DRAWN	DESIGNED	CHECK	APPROVED
P16220	KC	AH	BS	BS

PLAN NUMBERING CONVENTION		SECT
XXX1-XX/XX/XX		10 = GENERAL
		20 = NOT USED
		30 = EARTHWORKS
		40 = DRAINAGE
		50 = PAVEMENT
		60 = SIGNS & MARKS
		70 = NOT USED
		80 = MISCELLANEOUS

REV	DATE	BY	CHKD	DESCRIPTION
G	26.11.18	AH	AH	RE-ISSUED FOR DA CONDITION APPROVAL
F	01.11.18	AH	AH	RE-ISSUED FOR DA CONDITION APPROVAL
E	19.10.18	AH	AH	RE-ISSUED FOR DA CONDITION APPROVAL
D	23.03.18	KC	AH	RE-ISSUED FOR DA CONDITION APPROVAL
C	09.03.18	AH	AH	ISSUED FOR APPROVAL
B	11.10.17	AS	AH	ISSUED TO MRWA FOR APPROVAL
A	21.08.17	AH	AH	ISSUED FOR COSTING

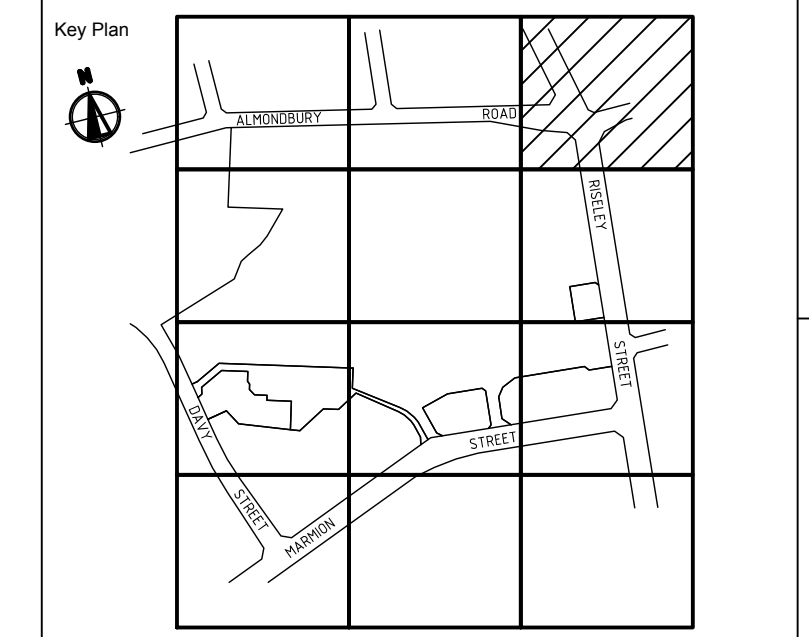

General Note: This drawing is for informational purposes only. It is not to be used for construction without the approval of the relevant authority. The contractor is responsible for confirming the locations of all existing services prior to construction.

Client: **AMP CAPITAL**
 Level 16, 50 Bridge Street, SYDNEY, NSW, 2000
 Phone: (02) 92572000



SCENTRE GROUP
 Scentre Design and Construction Pty Limited
 Suite 11, Level 1, 177-179 Davy Street, Booragoon
 Perth, WA 6154
 Phone (08) 9449 6315
 ACN 000 287 265

Perth Office —
 484 Murray St, Perth WA 6000
 P/F 61 8 6384 3300
 E / info@bgeng.com
 bgeng.com

**CIVIL DRAWING
 TRAFFIC SIGNS AND
 LINEMARKING
 SHEET 3**

Drawing No.	Scale	Scale Bar	Project No.	Plot Date
1:250	1:1	0 10 20 30 40 50	11502	

BGC-73.6023 G

DEPARTMENT OF PLANNING, LANDS AND HERITAGE
 DATE: 05-Nov-2021 FILE: SDAU-017-20

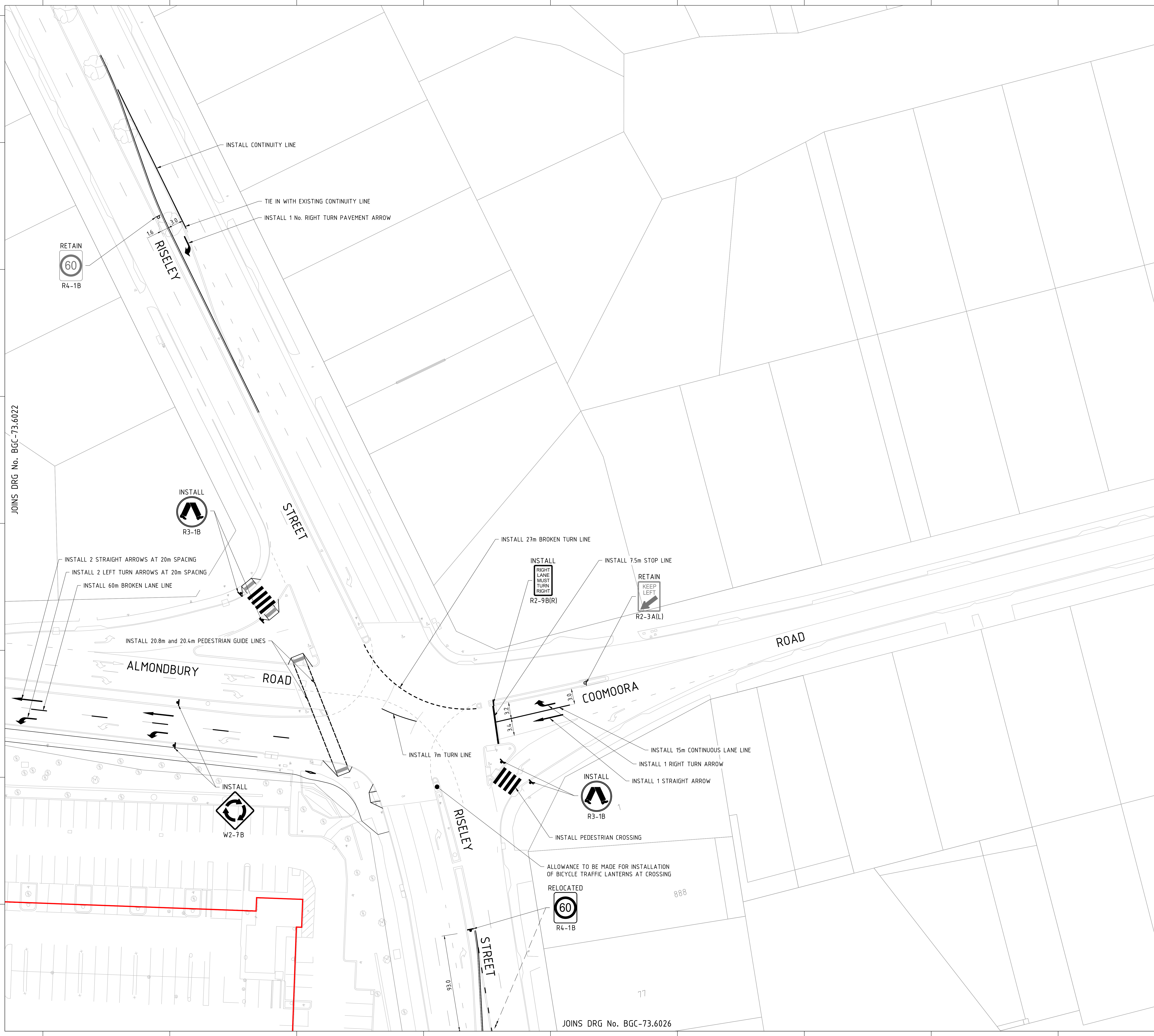

JOINS DRG No. BGC-73.6022

JOINS DRG No. BGC-73.6026

17

888

0.66

RISELEY STREET

COOMOORA ROAD

ALMONDBURY ROAD

RISELEY STREET

RISELEY

RETAIN R4-1B

INSTALL R3-1B

INSTALL R2-9B(R)

INSTALL R2-3 A(L)

INSTALL R3-1B

RELOCATED R4-1B

INSTALL W2-7B

INSTALL CONTINUITY LINE

TIE IN WITH EXISTING CONTINUITY LINE

INSTALL 1 No. RIGHT TURN PAVEMENT ARROW

INSTALL 2 STRAIGHT ARROWS AT 20m SPACING

INSTALL 2 LEFT TURN ARROWS AT 20m SPACING

INSTALL 60m BROKEN LANE LINE

INSTALL 20.8m and 20.4m PEDESTRIAN GUIDE LINES

INSTALL 27m BROKEN TURN LINE

INSTALL 7.5m STOP LINE

INSTALL 7m TURN LINE

INSTALL 15m CONTINUOUS LANE LINE

INSTALL 1 RIGHT TURN ARROW

INSTALL 1 STRAIGHT ARROW

ALLOWANCE TO BE MADE FOR INSTALLATION OF BICYCLE TRAFFIC LANTERNS AT CROSSING