

ATTACHMENT D – UPDATED LANDSCAPE REPORT (URBIS)

WESTFIELD BOORAGOON LANDSCAPE ARCHITECTURE PRESENTATION

09/08/2021

WESTFIELD BOORAGOON BOORAGOON PRECINCT VISION

The landscape design responds to the development as part of a wider Booragoon Parkland Precinct, offering a range of opportunities for interpretation and creating a sequence of different landscape and visual experiences.

The design works to enhance the existing site features and responds to the Melville residential setting through landscape treatment, material selection and built form.

The Landscape will help to shape spaces that are appropriate for a range of people, and a variety of different social activities, interest groups and sizes. External seating is provided and integrated within landscape spaces providing spaces for community gathering throughout the day and into the night.

Plant selection and materiality throughout the landscape will draw inspiration from Wireless Hill parkland and surrounding residential precinct. These elements flow throughout the landscape spaces, evolving as visitors experience the variety of spaces.



WESTFIELD BOORAGOON

BOORAGOON STORY

The identity of the parkland precinct will be developed and emphasized throughout Westfield Booragoon.

The landscape design will take cues from the surrounding residential area and Wireless Hill parkland. The design will adopt materials and forms which will be introduced to enhance precinct identity.

Relevant local stories will be described within the landscape treatments through interpretation to reflect and enhance the local context.

YAGAN MIA (WIRELESS HILL)

Wireless hill was known to be a camping place (mia), and lookout (genunny) of Yagan who is remembered as a well known and highly respected Nyoongar leader of the nineteenth century.

This area was used it as a home base, lookout, and a communication vantage point. European settlers saw the importance of this area, for similar reasons.

WATER STORY

Westfield Booragoon, is situated, just to the north of a lake system (now know as the Beeliam Regional Park Lake Chain) that was significant to Whadjuk Noongar people, and for the natural ecological systems which define this region. The following image illustrates this relationship at the northern end of Perth southern lakes network.

These lakes provided an important trail linking areas south of Perth with the Swan and Canning River systems.

Booragoon is the Aboriginal name for the lower reaches of the Canning River.

The Noongar people utilised the Booragoon Lake area as a camping site with ample food supplies and bird life. Booragoon Lake still provides refuge for a variety of bird life. It forms part of the Beeliam Regional Park chain and supports a great richness and abundance of wildlife, providing habitat, refuge, breeding grounds and sources of food for animals.

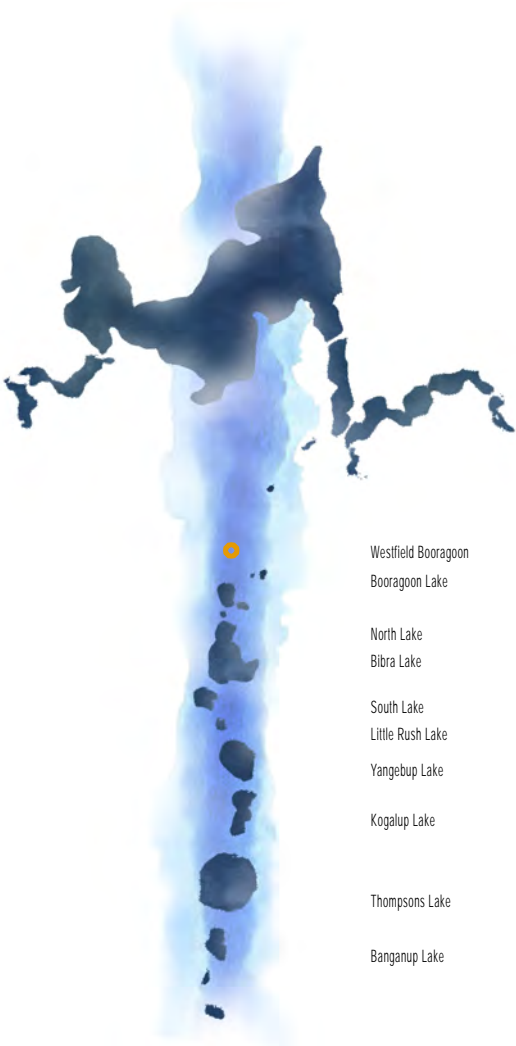

The background image shows a lush park setting. In the foreground, there are dense green plants with small yellow flowers. In the mid-ground, a person is walking on a path, their figure slightly blurred. The background is filled with more greenery and trees, creating a sense of a large, open park space.

WESTFIELD BOORAGOON

LANDSCAPE OBJECTIVES

- **DEVELOP A DISTINCTIVE LANDSCAPE CHARACTER AND SETTING**
- **CREATE SAFE, ACTIVE, VIBRANT PUBLIC SPACES FOR THE GREATER COMMUNITY**
- **ENHANCE MOVEMENT NETWORK WITHIN THE PRECINCT AND IMPROVE ACCESSIBILITY**
- **UNIFY THE WIDER PRECINCT TO PRESENT WESTFIELD BOORAGOON AS A DESTINATION WITHIN A PARKLAND SETTING**

WESTFIELD BOORAGOON KEY PRINCIPLES

ACTIVATION AND IDENTITY

- Emphasise the precinct identity through interpretation reflect the local context through character and form.
- Establish a series of distinctive landscape spaces to enhance the identity of the precinct.
- Establish a framework of green spaces linking the Westfield Centre, Mellville Community and Wireless Hill precinct.



CONNECTED PRECINCT

- Create an accessible and community-oriented destination that caters to a wide variety of people.
- Connect the Wireless Hill parkland through to Westfield Booragoon by developing an enhanced pedestrian access network for the precinct.
- Ensure a complementary relationship between the Westfield Centre and Mellville Community Precinct in which the activity and life of each can contribute to and enrich the other.



INTEGRATED LANDSCAPE

- Build on a framework of existing endemic trees located to integrate the centre into the surrounding parkland.
- Focus on spatial hierarchy, proportion, way-finding and passive surveillance.
- Incorporates the use of endemic local species, avenue planting and feature species, telling the story of the Noongar six seasons through plantings of selected seasonal species.



WESTFIELD BOORAGOON

LANDSCAPE STRATEGIES

ACTIVATION AND IDENTITY

1. Convey the identity of Booragoon through interpretation.
2. Create a precinct heart within the Town Square by working with City of Melville to improve synergies between Westfield and City of Melville destination spaces.
3. Provide a safe and vibrant experience to support evening activity.
4. Create a weather protected heart that provides a variety of flexible-use social gathering spaces.
5. Introduce a network of strategically placed gathering areas and retail opportunities to activate public realm.
6. Create a welcoming, dynamic and inclusive destination engaged with its community
7. Draw upon the identity of the camping place (mia), and lookout (genunny) of Yagan mia (Wireless hill).
8. Enhance way-finding and legibility with the introduction of sculpture and signage.



Shade Canopy



Entry Signage



Water Feature



Food and Beverage



Library



Shopping / Retail



Sculpture / Artwork



Town Square



Playground

CONNECTED PRECINCT

1. Create a circulation structure of perimeter footpaths, internal pedestrian avenues, and parklands.
2. Create a strong internal pathway coherence allowing an easily navigable precinct.
3. Create a legible and vibrant circulation routes throughout the precinct.
4. Facilitate a pedestrian dominant environment by incorporating underground/roof car parking
5. Pedestrianize high street with vehicle access limited to public transport and drop-off zones.
6. Improve public transport connections and encourage use of public transport by working with authorities to provide an accessible bus stop on High Street.
7. Increase pedestrian safety at night by enhancing lighting throughout the precinct.
8. Encourage active transport by providing secure bike parking options and end of trip facilities.



Car Parking



Pedestrian Crossing



Entry /Exit



Bike Friendly



Seating Zone



Bus Port



Pedestrian Footpath



Precinct Lighting



End of Trip

INTEGRATED LANDSCAPE

1. Provide a sense of arrival with a distinctive landscape character.
2. Prioritise use of endemic plant species.
3. Maintain significant existing trees within the precinct where possible.
4. Build on the existing tree canopy to encapsulate the precinct.
5. Enhance tree canopy and soft landscape spaces to assist in cooling the precinct.
6. Draw upon different seasonal themes of the Noongar Six Seasons to help give context to stories told through the landscape.
7. Optimise outdoor amenity, creating distinctive landscape settings that respond to, built form at building frontages, balcony and rooftop areas and the spaces between buildings.
8. Integrate sustainable design practises and adaptable, robust green infrastructure through introduced planting and water conservation.



Avenue Tree Planting



Facade Planting



Recreation Lawn



Six Seasons Planting



Retained Feature Tree



Bush Walking Trail



Enhanced Tree Canopy



Water-wise planting



Green Roof

WESTFIELD BOORAGOON BOORAGOON PARKLAND PRECINCT

WIRELESS HILL RESERVE

BOORAGOON ACTIVITY CENTRE

LANDSCAPE DESIGN PRINCIPLES

The landscape design for the Westfield Booragoon Development will provide external amenity for visitors to the centre as well as enrich the broader public realm and future City of Melville Community Precinct. Landscape spaces will complement the retail activities by providing a places for entertainment, rest, relaxation and dining both during the day and into the night.

Together the Westfield Booragoon and City of Melville precincts will develop a symbiotic relationship where the activity of one enriches the other. The concept plan for the public realm includes a new town square, a High Street, internal pedestrian links and enhanced treatment to the perimeter roads.

The design draws inspiration from the established landscape setting of Wireless Hill. The development willll provide a vibrant heart to the centre which will support on-going activity within the parkland precinct.

WESTFIELD BOORAGOON
WESTFIELD BOORAGOON LANDSCAPE MASTER PLAN



TOWN SQUARE DESIGN PRINCIPLES

TOWN SQUARE DESIGN STATEMENT

The landscape concept for the Town Square will create a new 'green heart' for Westfield Booragoon.

Located off the High Street this proposed Town Square will provide visitors to the centre with a destination to interact, shop and dine and enjoy the atmosphere.

The square is designed as a flexible space offering a range of highly programmed activated spaces. The spaces are adaptive to a range of programs and functions and will support social and community interaction.

The town square will be a welcoming place that functions during the day and night offering a safe and inclusive environment for all.

KEY ASPECTS:

- **CREATE A PRECINCT HEART WITHIN THE TOWN SQUARE BY WORKING WITH CITY OF MELVILLE TO IMPROVE SYNERGIES BETWEEN WESTFIELD AND CITY OF MELVILLE DESTINATION SPACES.**
- **PROVIDE A SAFE AND VIBRANT EXPERIENCE TO SUPPORT EVENING ACTIVITY.**
- **CREATE A WEATHER PROTECTED HEART THAT PROVIDES ADEQUATE SHADE PROVISION (TREE CANOPY OR ARCHITECTURAL)**

- **PROVIDE A VARIETY OF FLEXIBLE-USE SPACES FOR SOCIAL GATHERING.**
- **INTRODUCE A NETWORK OF STRATEGICALLY PLACED GATHERING AREAS AND RETAIL OPPORTUNITIES TO ACTIVATE PUBLIC REALM.**
- **CREATE A WELCOMING, DYNAMIC AND INCLUSIVE DESTINATION ENGAGED WITH ITS COMMUNITY.**
- **OPTIMISE OUTDOOR AMENITY, CREATING DISTINCTIVE LANDSCAPE SETTINGS THAT RESPOND TO, BUILT FORM AT BUILDING FRONTAGES, BALCONY AND ROOFTOP AREAS AND THE SPACES BETWEEN BUILDINGS.**



LEGEND:

- ← - - - → PRIMARY PEDESTRIAN ACCESS
- ▲ RETAIL CENTRE ENTRY

LEGEND:

1. FLEXIBLE-USE SPACE
2. WATER PLAY
3. WATER FEATURE
4. LAWN SPACE
5. ALFRESCO DINING
6. CANOPY SHADE
7. PERFORMANCE STAGE SPACE
8. PLAYGROUND
9. DESTINATIONAL DINING PRECINCT
10. COMMUNITY / COUNCIL PRECINCT

WESTFIELD BOORAGOON

PERIMETER TREE RETENTION

The retention of established trees surrounding the perimeter of the site will assist in emphasising a distinct sense of place for the development.

Where it is possible to do so the existing tree canopy will be retained to ensure a tree canopy surrounds the booragoon activity precinct. The existing canopy will be enhanced with additional advanced tree plantings as part of the development.

Proposed additional tree planting will be endemic species to complement the existing vegetation. The intent is to create a shady tree canopy surrounding the perimeter too provide a parkland feel and provide shade to pedestrians visiting the centre.

KEY ASPECTS:

- MAINTAIN EXISTING TREES WITHIN THE PRECINCT WHERE POSSIBLE.
- BUILD ON THE EXISTING CANOPY TO ENCAPSULATE THE PRECINCT.
- ENHANCE TREE CANOPY TO ASSIST IN COOLING THE PRECINCT.
- OPTIMISE OUTDOOR AMENITY, CREATING DISTINCTIVE LANDSCAPE SETTINGS THAT RESPOND TO, BUILT FORM AT BUILDING FRONTAGES, BALCONY AND ROOFTOP AREAS AND THE SPACES BETWEEN BUILDINGS.

LEGEND:

- RETAINED EXISTING TREES
- PROPOSED ADDITIONAL TREES
- SITE BOUNDARY

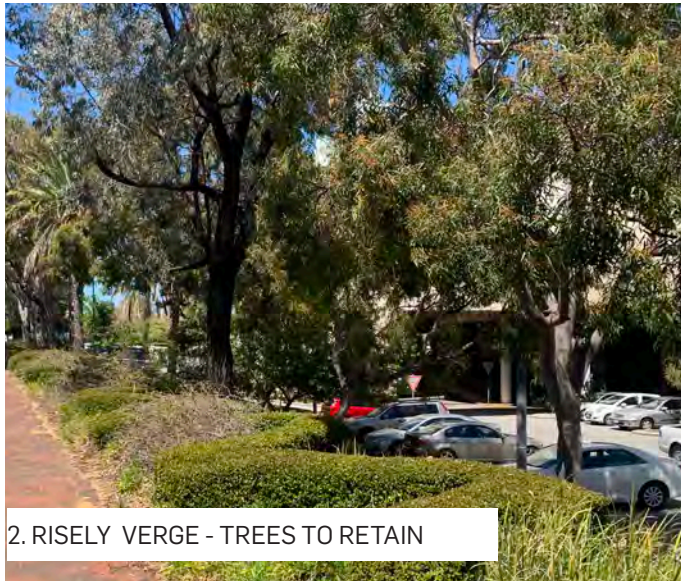

EXISTING TREES WITHIN THE SITE BOUNDARY

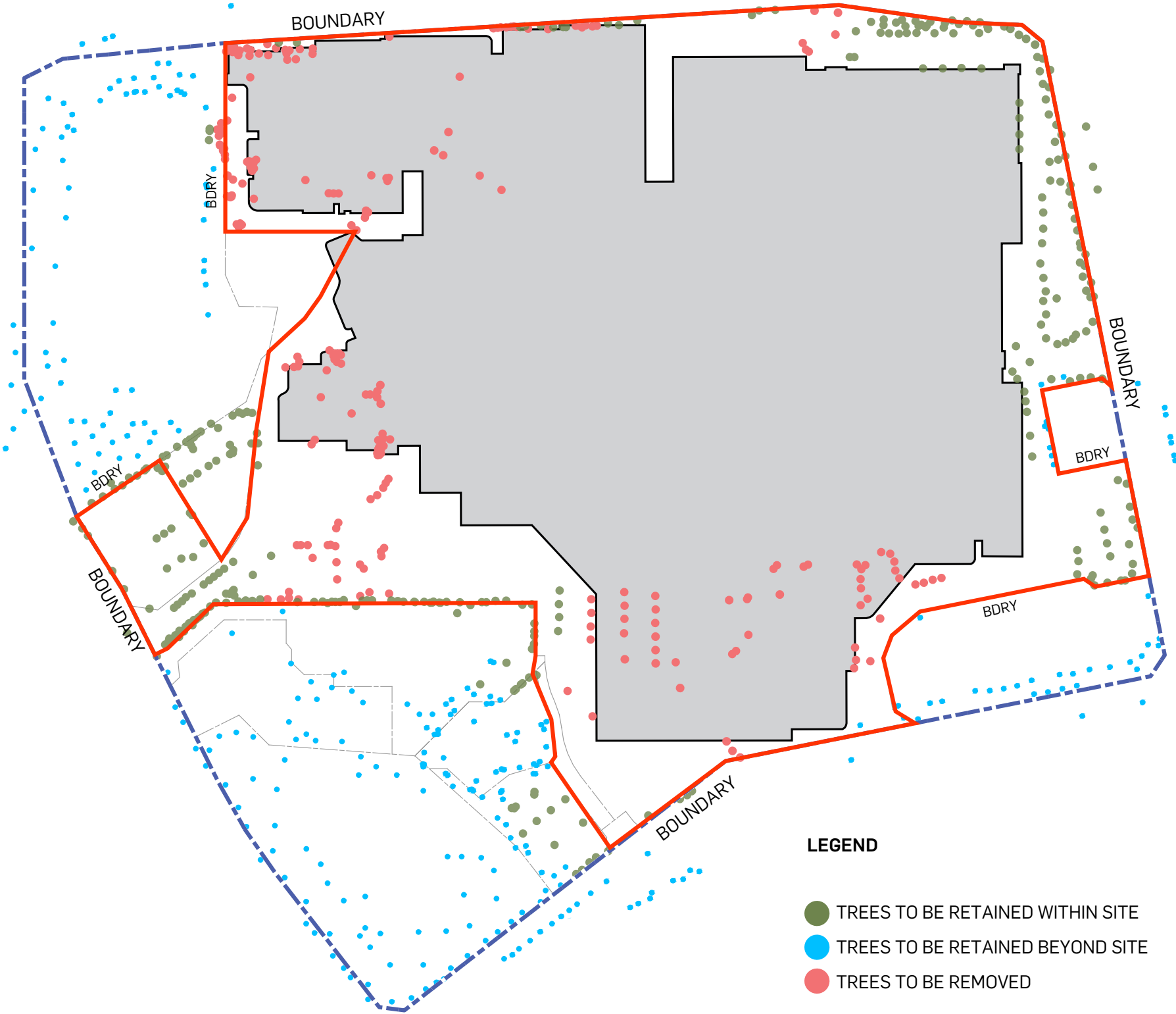

KEY ASPECTS:

- **LARGE VARIETY OF BOTH ENDEMIC AND NATIVE PLANTINGS INTERSPERSED WITH A RANGE OF EXOTIC PALMS AND DECIDUOUS TREES ACROSS THE SITE.**
- **A LACK OF COORDINATION IN PLANTING DESIGN HAS RESULTED IN A VISUALLY UNCOORDINATED LANDSCAPE.**
- **THE MAJORITY OF SPECIES PLANTED THROUGHOUT THE CAR PARKS ARE SPECIES THAT ARE NOT SUITABLE FOR TRANSPLANTING.**
- **SPECIES SUITABLE FOR TRANSPLANT WILL BE CONSIDERED FOR USE IN SUITABLE LOCATIONS.**
- **EXISTING TREES WILL BE RETAINED WHERE APPROPRIATE FOR USE WITHIN THE WESTFIELD BOORAGOON DEVELOPMENT.**
- **EXTENSIVE RESOLUTION WILL BE REQUIRED TO ENSURE RETENTION AND ONGOING PROTECTION.**
- **MAINTAIN EXISTING TREE CANOPY TO PROVIDE A SENSE OF ARRIVAL WITH A DISTINCTIVE LANDSCAPE CHARACTER.**

WESTFIELD BOORAGOON PLANTING DESIGN

The planting scheme will be dominated by species endemic to the site, emphasising a distinct sense of place for the development. The endemic plants are appropriate to the local environment and can be expected to be tolerant to local conditions, helping to ensure survival and better growth, as well as reducing ongoing irrigation and maintenance requirements.

Street planting will be native to complement the existing vegetation and create a parkland experience surrounding the centre.

Exotic species will be used where appropriate and will be selected to provide appropriate amenity, reference the history of the site, provide shade and better growth in the constructed environment.

Deep soil zones surround the site and enable planting of significant vegetation, which can grow to a mature size and provide a canopy within the precinct.

In addition to the deep soil zones a rootable soil zone, achieved through the use of structural cells and located under adjacent pavements will help improve the planting opportunities within hard surface spaces.

In areas on-slab where a tree canopy is desired the design will incorporate raised garden beds to provide sufficient soil depth for canopy trees.

KEY ASPECTS:

- **INTEGRATION OF FEATURE, SHADE AND WSUD PLANTING TO ENHANCE PLANTING SCHEME AND WATER RETENTION OPPORTUNITIES**
- **CULTURALLY SIGNIFICANT PLANTING**
- **PRIORITISE USE OF ENDEMIC PLANT SPECIES.**
- **LOW MAINTENANCE PLANTING TO INTERNAL PLANTING AREAS**
- **ENDEMIC AND EXOTIC SPECIES RETAINED ON SITE WHERE POSSIBLE TO PROVIDE AN ESTABLISHED AND PARK FEEL**
- **RANGE OF TREE STOCK SIZES TO PROVIDE AN IMMEDIATE IMPACT UPON OPENING**
- **PROVIDE A SENSE OF ARRIVAL WITH A DISTINCTIVE LANDSCAPE CHARACTER.**
- **BUILD ON THE EXISTING TREE CANOPY TO ENCAPSULATE THE PRECINCT.**
- **ENHANCE TREE CANOPY AND SOFT LANDSCAPE SPACES TO ASSIST IN COOLING THE PRECINCT.**

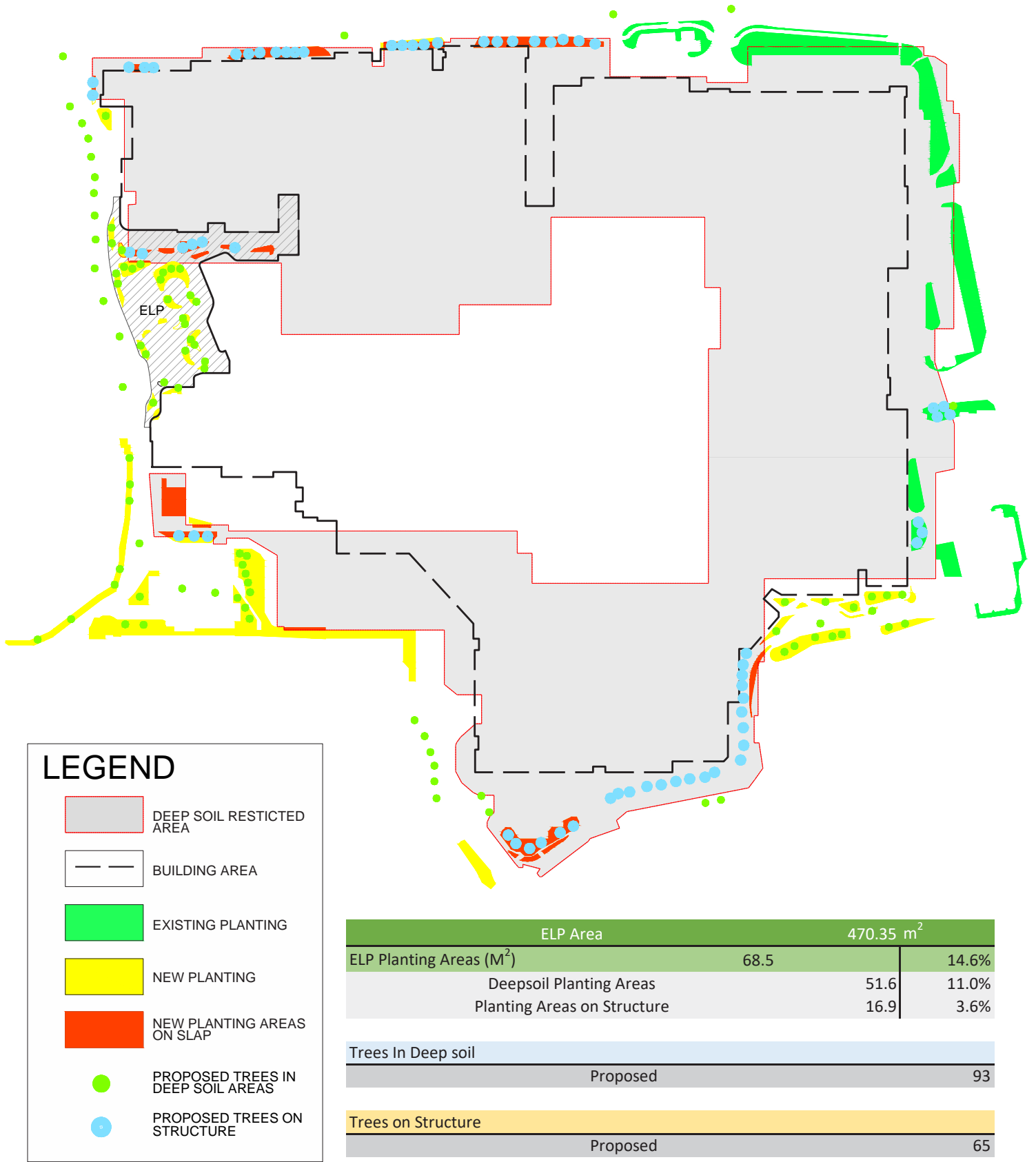

THE SIX SEASONS

THE NOONGAR SIX SEASONS

Noongar people have traditionally hunted and gathered food according to the six seasons which are determined by changing weather patterns. In the Noongar language the six seasons are called Birak, Bunuru, Djeran, Makuru, Djilba and Kambarang.

Each of the six seasons represents and explains the seasonal changes seen annually and provides a guide to what nature is doing at every stage of the year. There are subtle variations that signal the transition from one season to another. The flowering of endemic plant species, changes in weather and which bush foods are abundant provide helpful indicators that the seasons are changing.

The landscape design for Westfield Booragoon will incorporate the use of endemic species, familiar to the Noongar people.

The planting scheme is used as an interpretive element, telling the story of the Noongar six seasons through plantings of selected seasonal species.

The plantings are separated into six displays to show colour during each of the six seasons. These groupings will come alive at appropriate times of year displaying colour and interest in the relevant spaces.

Additionally the seasonal change also defined actions for the people such as how they sourced food (fires, traps, what plants they were available and chasing them), where they were (migrating inland, on the coast and in an area where the rain is).

DJILBA - BECOMING WARMER

Late Winter: August, September

KAMBARANG - THE FLOWERING

Wild flower Season: October, November

KEY ASPECTS:

- **USE OF ENDEMIC SPECIES EXAGGERATING THE SEASONAL CHANGES**
- **6 SEASON PLANTING HIGHLIGHTING THE NOONGAR TRADITIONS OF HUNTING AND GATHERING THROUGH REALISATION OF CLIMATE AND ENVIRONMENTAL CHANGES.**
- **GROUPINGS OF PLANTS WILL COME ALIVE AT APPROPRIATE TIMES OF THE YEAR DISPLAYING COLOUR AND INTEREST IN RELATIVE SPECIES**

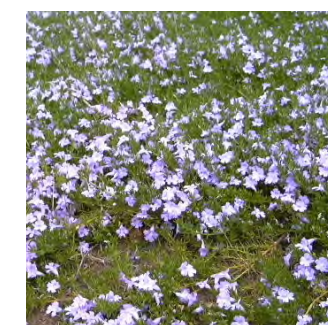
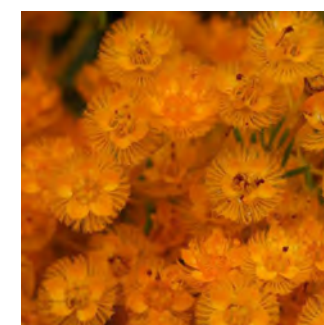

BIRAK - HOT AND DRY

The First Summer: December, January

BUNURU - FRUITING

The Second Summer: February, March

DJERAN - FIRST RAINS

The Autumn: April, May

MAKURU - THE COLD AND WET

Early Winter: June, July

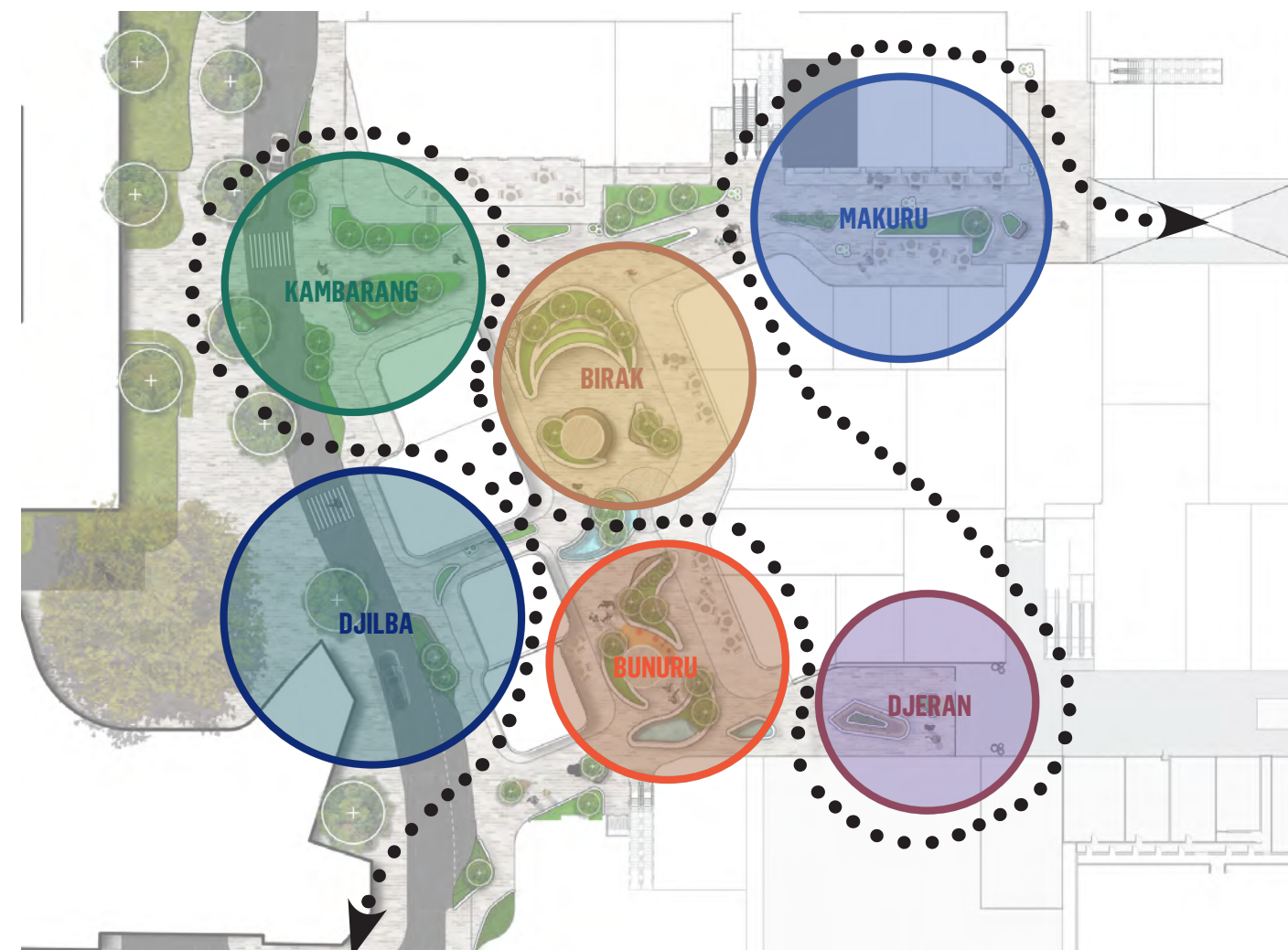

MATERIAL SELECTION

The landscape character of the site will use a restrained palette of materials within a contemporary style.

Materials will be high quality and durable in accordance with the location and significance of the project. The materials and colours will be selected to complement the built form architecture and allow the tree canopy to be the dominant landscape feature on site.

Materials and landscape furniture elements will be selected with consideration for maintenance, robustness and minimised applied finishes. High-quality finishes and materials will be utilised in high amenity landscape features within the primary public spaces, particularly the pedestrian links and community parklands.

The following imagery is indicative of the desired character of the precinct and is subject to further design development to confirm appropriateness and availability.

KEY ASPECTS:

- **ESTABLISHES AN IDENTITY FOR WESTFIELD BOORAGOON**
- **BLENDS AND CONTRIBUTES TO THE PARKLAND PRECINCT SETTING; AND**
- **PROVIDES A QUALITY OF AMENITY TO SUPPORT THE NEEDS OF THE LOCAL COMMUNITY.**



SCULPTURAL WATER FEATURES



STONE WALLS



OFF FORM CONCRETE



TIMBER DECKING WITH INTEGRATED PLANTERS



SIX SEASONS PLANTING



SANDSTONE/LIMESTONE CLADDING



INSITU CONCRETE SEATING WALLS



PEDESTRIAN PAVING - STONE



TIMBER SCREEN FENCING

WESTFIELD BOORAGOON

KEY AREA A - ALMONDBURY ROAD ENTRY



KEY PLAN A

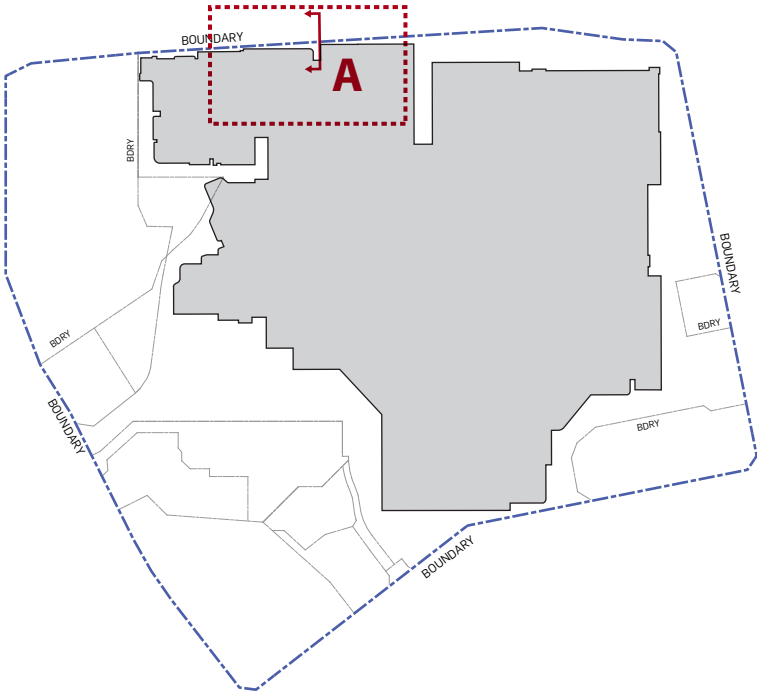

KEY ASPECTS:

- CLEAR AND DEFINED ENTRY TO THE WESTFIELD BOORAGOON THAT ACTS AS AN INSTINCTIVE PEDESTRIAN WAY-FINDING NODE
- PROVIDE ACCESS FROM PRIMARY ARRIVAL POINTS SUCH AS CAR AND BUS PARKING
- ALIGN ACCESS TO THE INTERNAL MALL WITH KEY EXTERNAL PEDESTRIAN PATH NETWORK
- BUILT FORM AND MATERIALITY RELATES TO ITS RESIDENTIAL CONTEXT.
- INTEGRATING GATHERING AND CIRCULATION SPACES.
- POTENTIAL TO RETAIN EXISTING TREES WHERE APPROPRIATE

WESTFIELD BOORAGOON

KEY AREA A - ALMONDBURY ROAD ENTRY



NOTE: PLANT SELECTION HAS BEEN MADE WITH REFERENCE TO THE CITY OF MELVILLE
APPROVED TREE PLANTING LIST AND RELEVANT WIRELESS HILL PLANTING REFERENCES

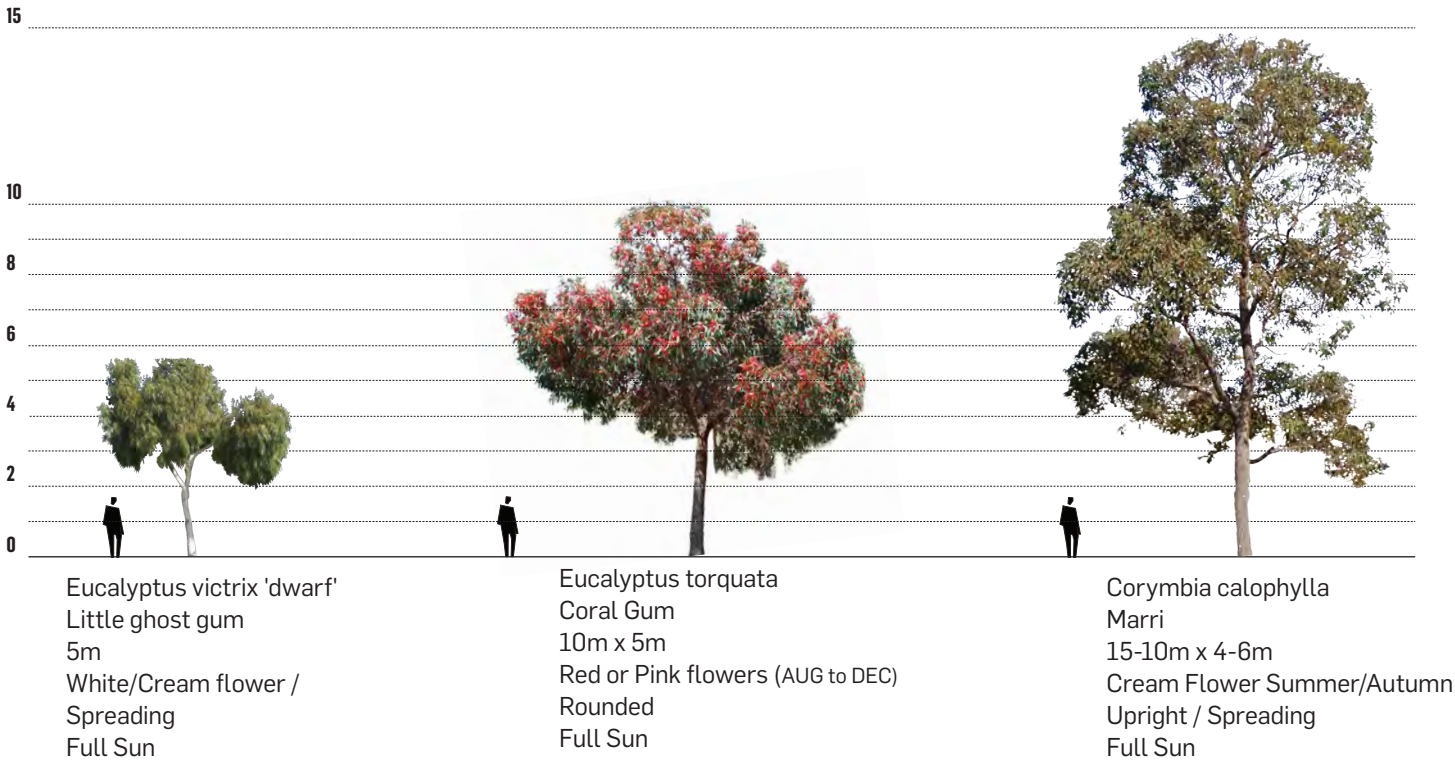

FEATURE TREES



Eucalyptus torquata



Corymbia Calophylla



Eucalyptus victrix 'Ghost Gum'

SHRUB AND GROUND COVER SPECIES



Leucophyta brownii



Conostylus candicans



Westringia fruticosa



Olearia axillaris



Chrysocephalum
'Silver Sunburst'



Calothamnus quadrifidus

CASCADING SPECIES



Hemiantra pungens



Casaurina glauca 'Cousin It'

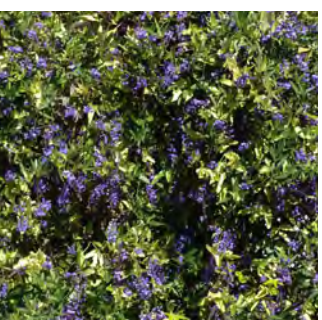

Hardenbergia comptoniana



Acacia cognata



Hibbertia scandens

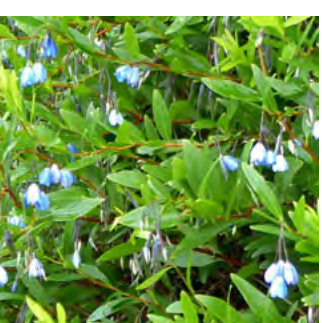

Billardiera heterophylla

WESTFIELD BOORAGOON
KEY AREA A - ALMONDBURY ROAD ENTRY

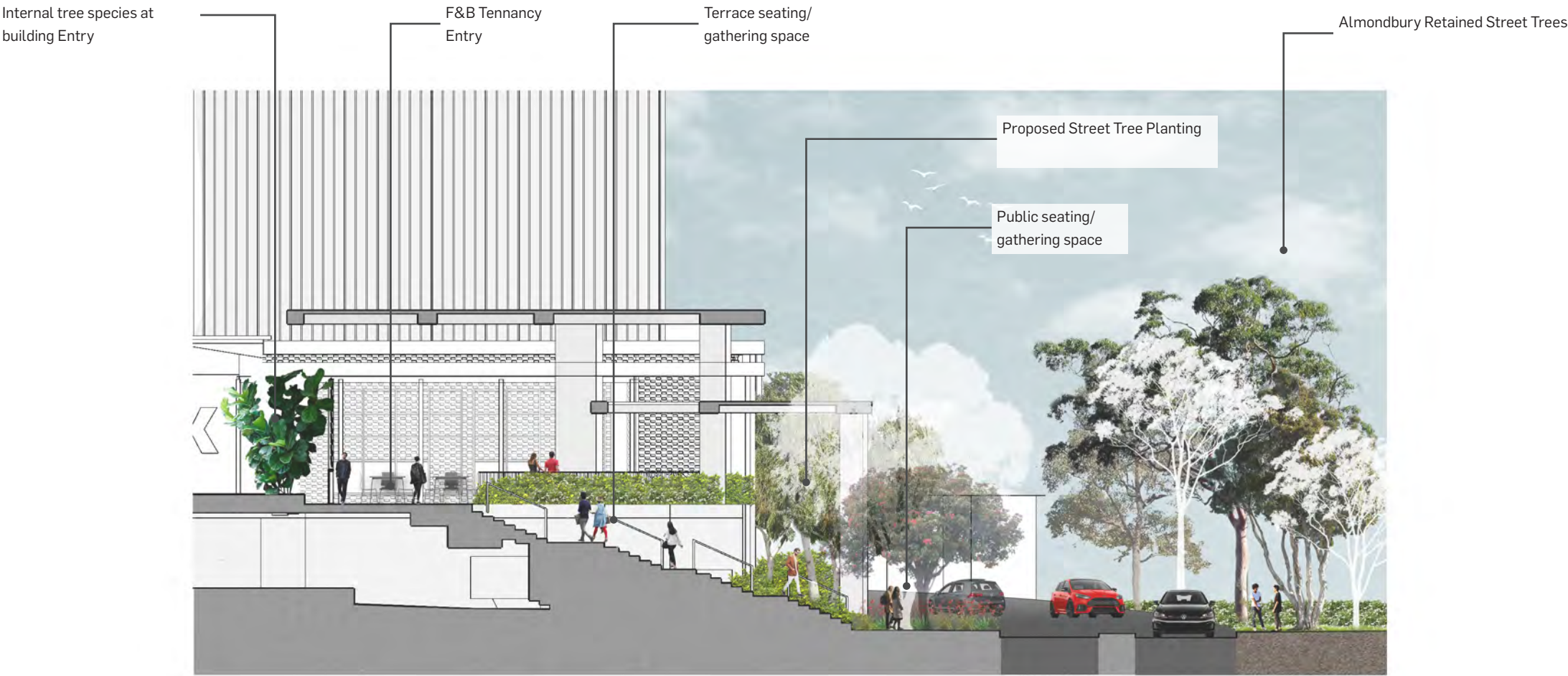
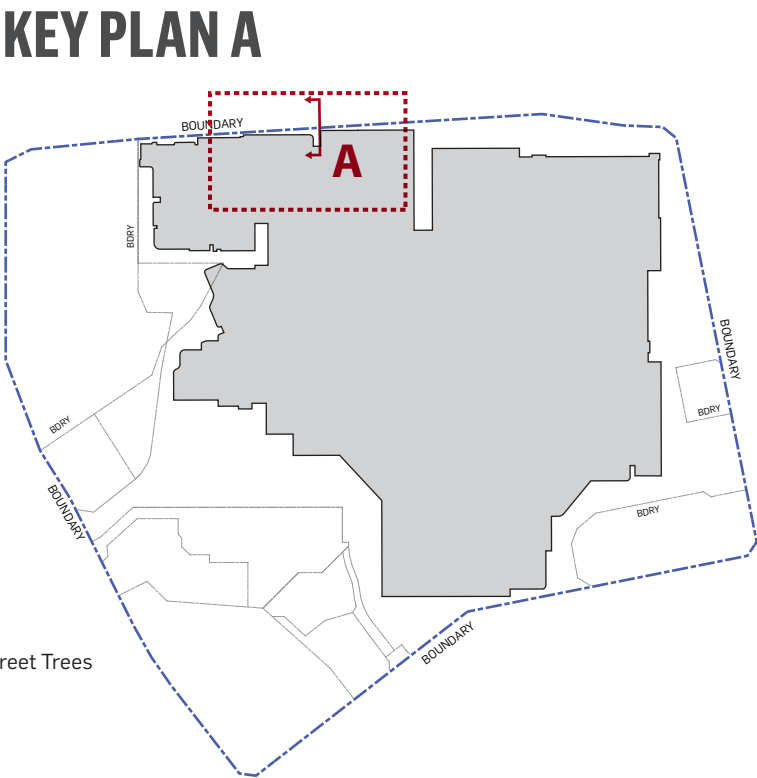

A-A _ ALMONDBURY ROAD NORTH SOUTH SECTION - 1:200 @ A3

WESTFIELD BOORAGOON

KEY AREA B - HIGH STREET



KEY PLAN B

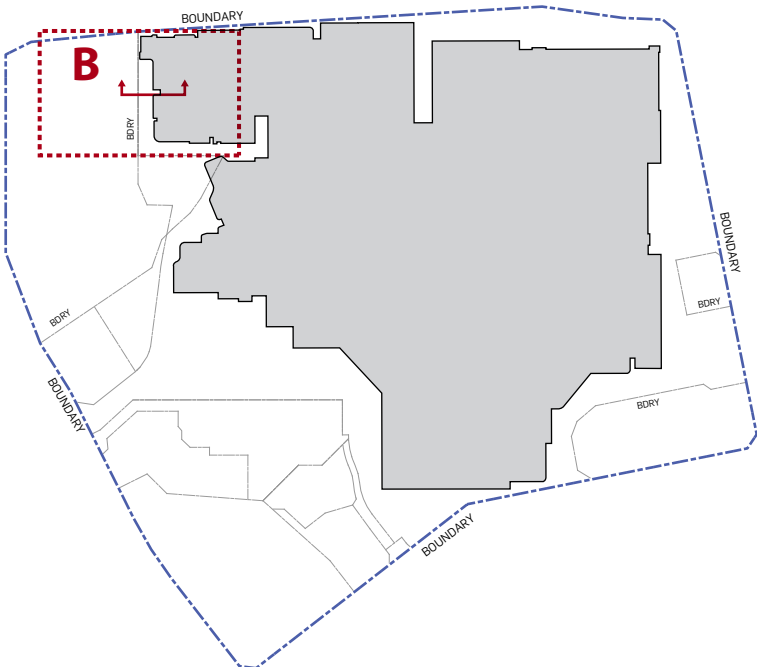

KEY ASPECTS:

- **CREATE A PRIMARY ENTRY TO WESTFIELD BOORAGOON**
- **PROVIDE UNIVERSAL ACCESS FROM CAR AND BUS PARKING**
- **ACTS AS AN INSTINCTIVE PEDESTRIAN WAY-FINDING NODE**
- **ADAPT THE LANDSCAPE TREATMENTS TO RESPOND TO THE BUILDING FORM**
- **PROVIDE A PEDESTRIAN CONNECTION TO THE MELVILLE COUNCIL PRECINCT AND WIRELESS HILL**

WESTFIELD BOORAGOON

KEY AREA B - HIGH STREET

NOTE: PLANT SELECTION HAS BEEN MADE WITH REFERENCE TO THE CITY OF MELVILLE
APPROVED TREE PLANTING LIST AND RELEVANT WIRELESS HILL PLANTING REFERENCES

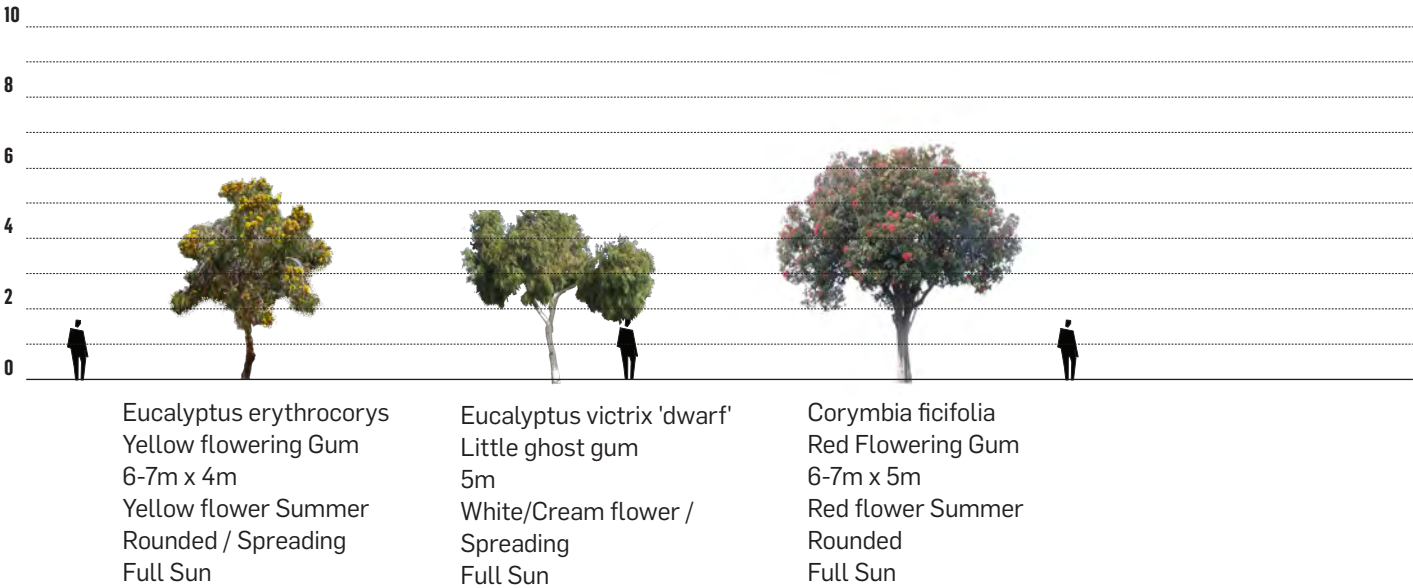

FEATURE TREES



Corymbia ficifolia



Eucalyptus erythrocorys

FEATURE - 6 SEASON SPECIES



Xanthorrhoea preissii



Lechenaultia biloba



Verticordia nitens

SHRUB AND GROUNDCOVER SPECIES



Lomandra longifolia



Chrysocephalum apiculatum



Leucophyta brownii



Eucalyptus victrix 'Ghost Gum'



Eucalyptus macrocarpa



Anigozanthos manglesii



Eremophila nivea



Callistemon glauca 'Little Tom'



Anigozanthos sp.



Conostylus candicans

WESTFIELD BOORAGOON

KEY AREA B - HIGH STREET

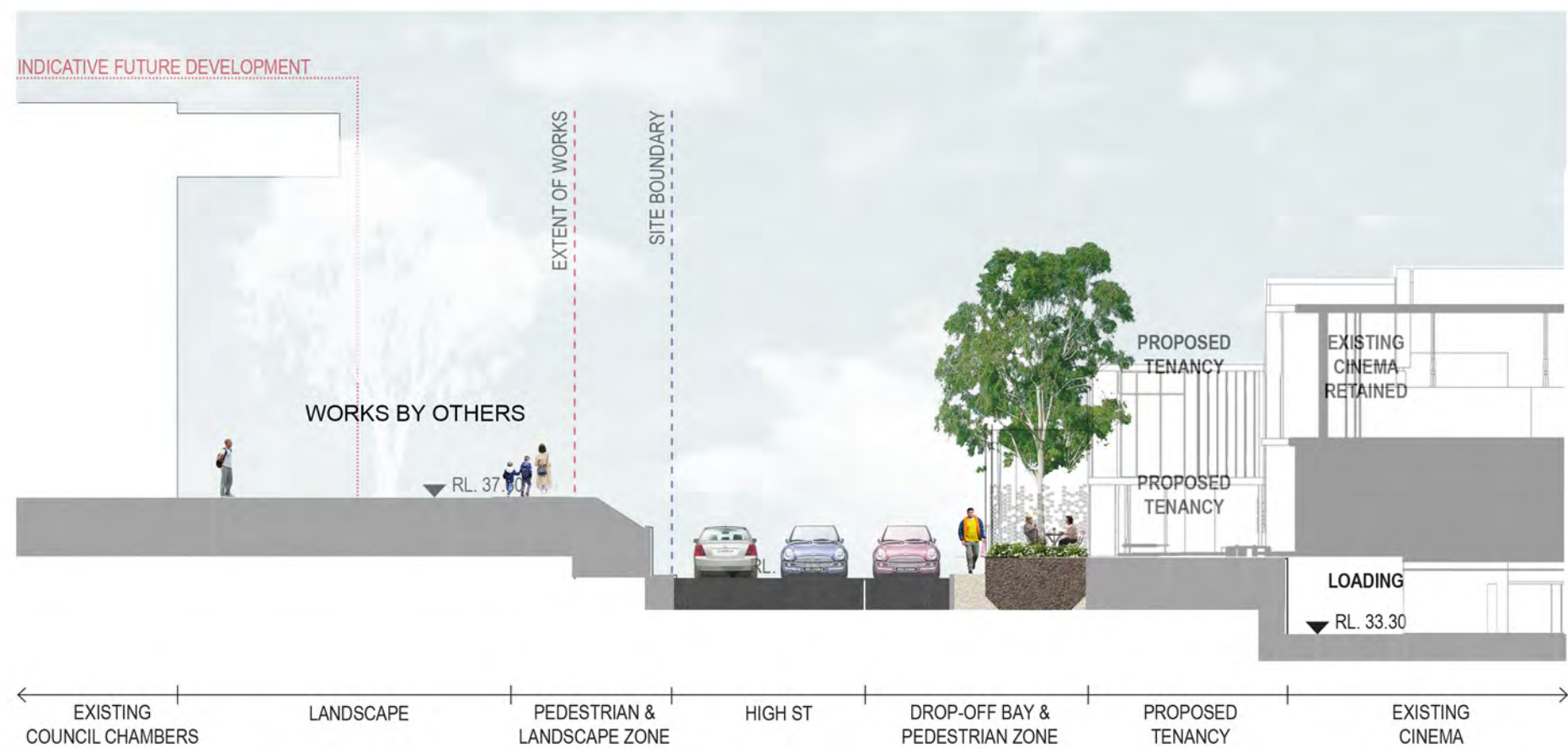

B-B _ HIGH STREET EAST WEST SECTION - 1:200 @ A3

KEY PLAN B

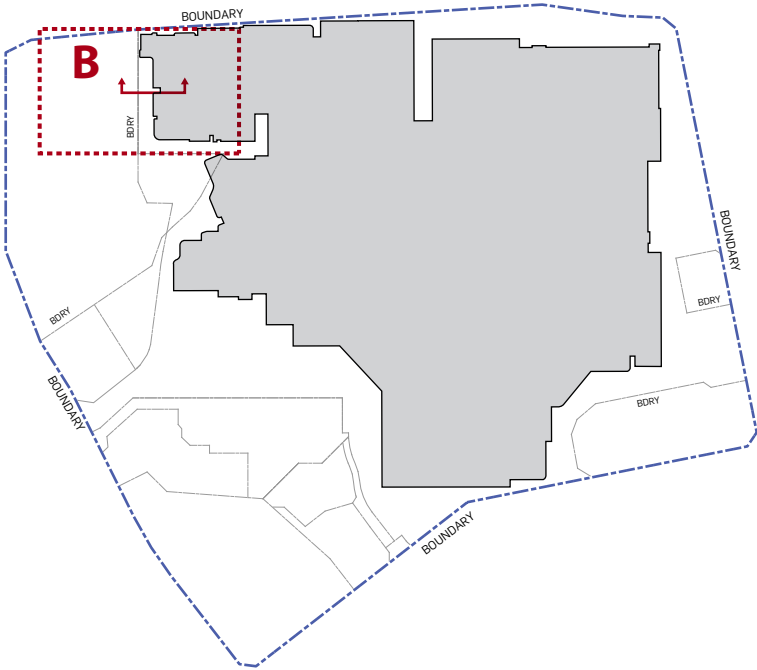

WESTFIELD BOORAGOON

KEY AREA C - EVENT PLAZA - CENTRE ENTRY

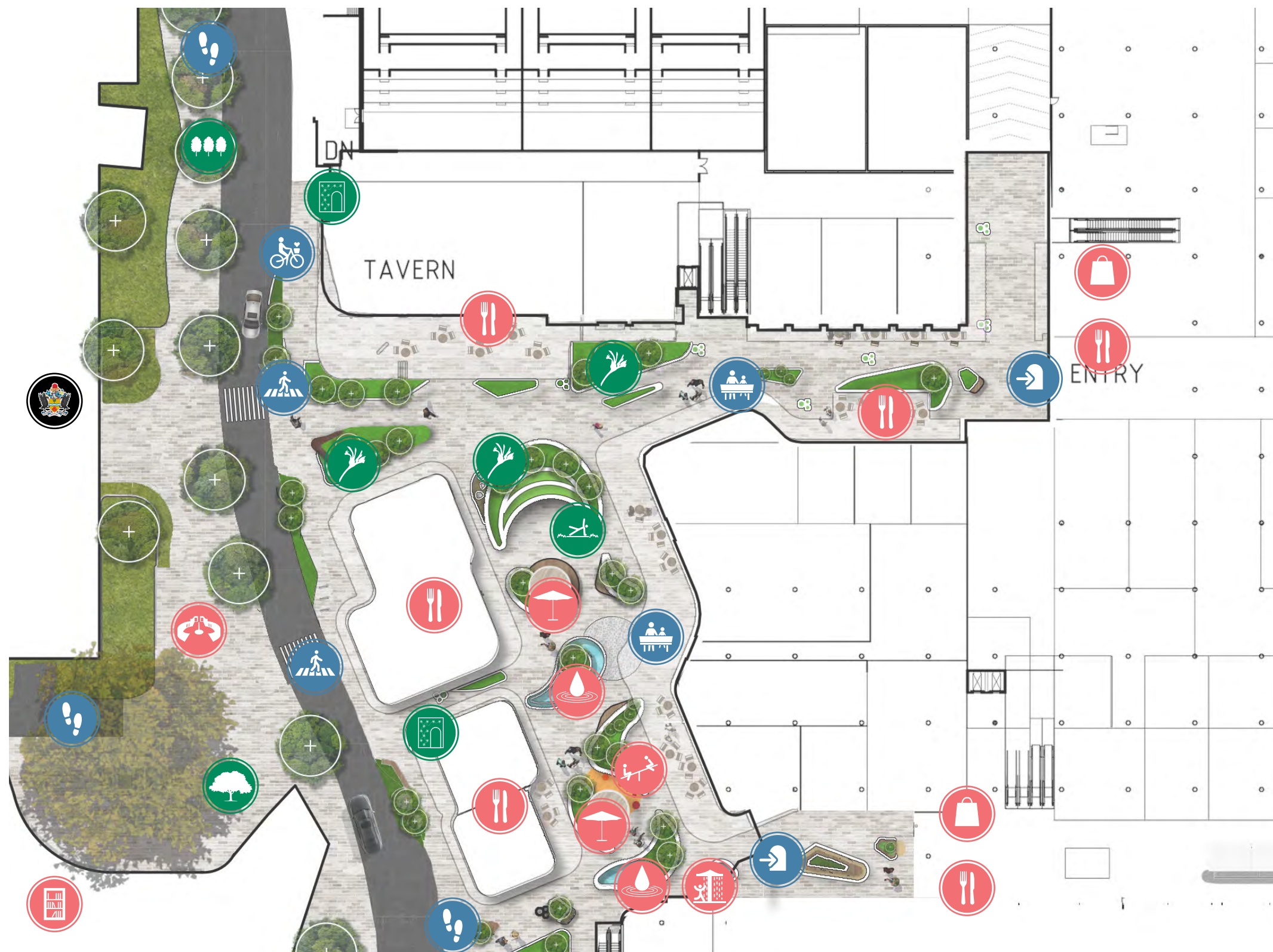

KEY PLAN C

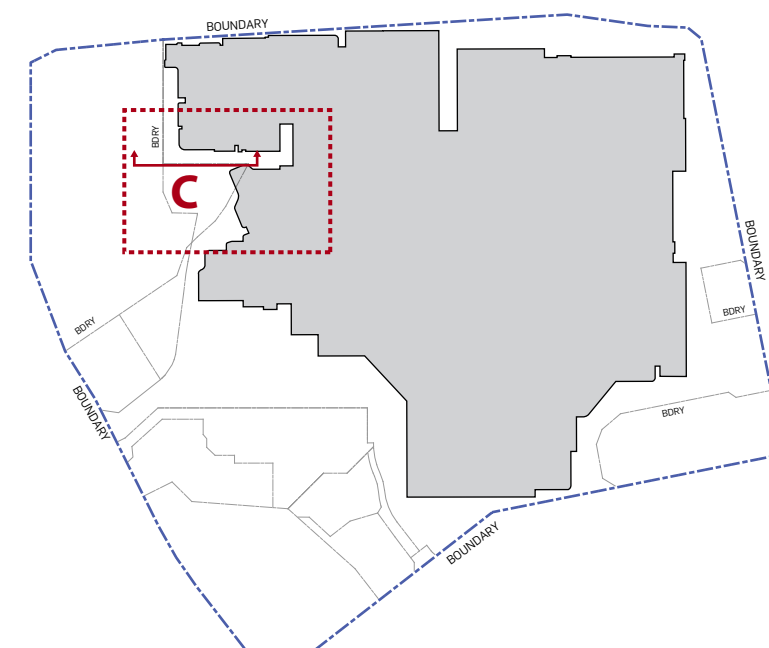

KEY ASPECTS:

- PROVIDES THE PRIMARY GATHERING/ DESTINATION SPACE FOR THE LOCAL COMMUNITY AND VISITORS
- LINKS INTERNAL RETAIL SPACE TO PRIMARY ACCESS AND PARKING
- A VARIETY OF LANDSCAPE TREATMENTS / FORMS ALLOW FOR A WIDE RANGE OF GATHERING AND EVENT SPACES
- HIGH QUALITY LANDSCAPE FINISHES AID IN WAY-FINDING AND AESTHETIC IMPRESSION
- INTEGRATING LIGHTWEIGHT SOLUTIONS THAT ALLOW PLANTING AND STRUCTURE ON SLAB
- WORKING WITH LEVELS TO ALLOW FOR PLANTING AND TREES ABOVE BASEMENT / SERVICES

WESTFIELD BOORAGOON

KEY AREA C - EVENT PLAZA - CENTRE ENTRY

NOTE: PLANT SELECTION HAS BEEN MADE WITH REFERENCE TO THE CITY OF MELVILLE APPROVED TREE PLANTING LIST AND RELEVANT WIRELESS HILL PLANTING REFERENCES

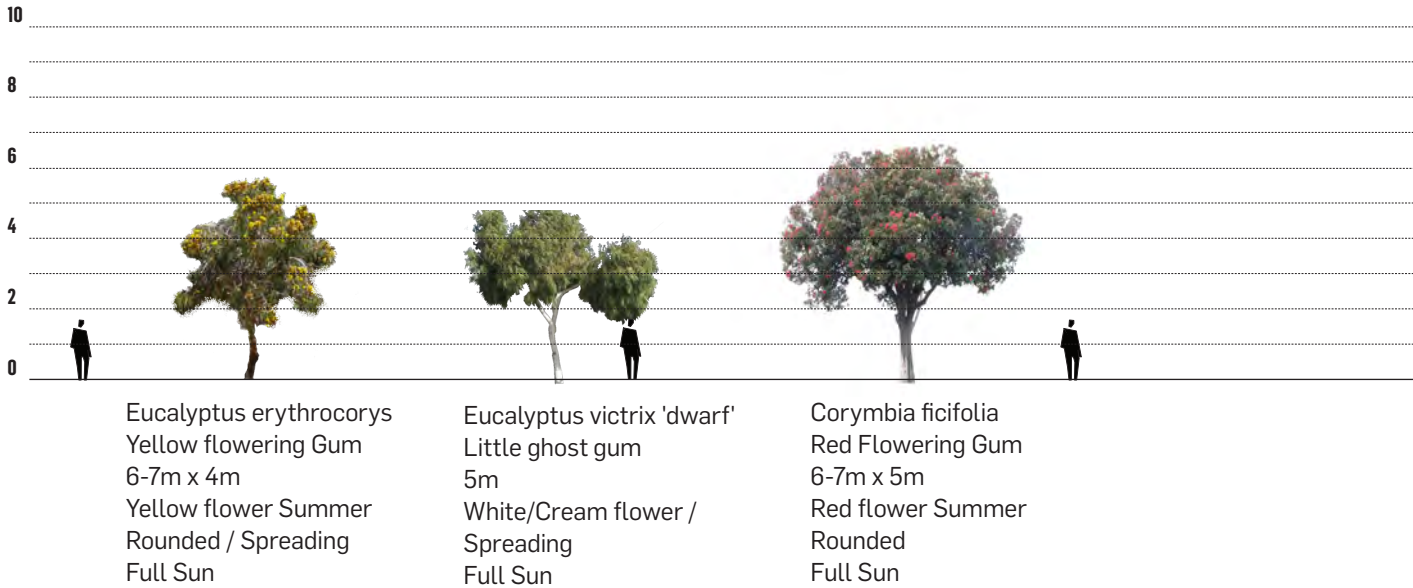

FEATURE TREES



Corymbia ficifolia



Eucalyptus erythrocorys



Beaufortia elegans



Conostylus candicans



Verticordia mitchelleana



Xanthorrhoea preissii



Eucalyptus victrix 'dwarf'



Macrozamia riedlei



Verticordia aurea



Pimelea feruginea

SHRUB AND GROUNDCOVER SPECIES



Leucophyta brownii



Adenanthos cuneatus



Lomandra confertifolia

WESTFIELD BOORAGOON
KEY AREA C - EVENT PLAZA - CENTRE ENTRY

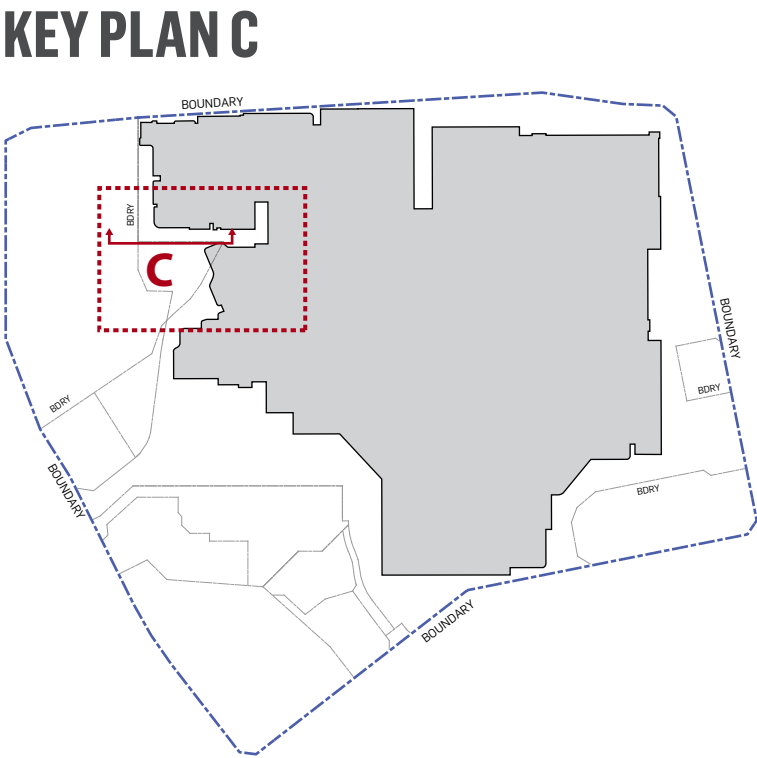

C-C _ HIGH STREET EAST WEST SECTION - 1:200 @ A3

WESTFIELD BOORAGOON

KEY AREA D - COUNCIL / COMMUNITY



KEY PLAN D

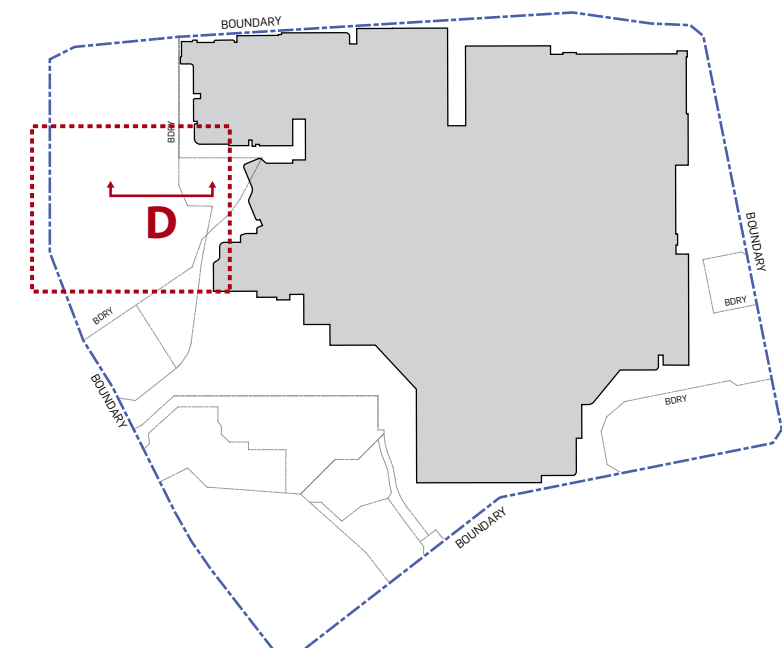

KEY ASPECTS:

- A SPACE DEDICATED TO COMMUNITY ACTIVITY AND CELEBRATION
- FEATURES SIGNIFICANT RETAINED PLANTING THAT ENHANCES THE PRECINCT PARKLAND VISION
- A MULTI-PURPOSE SPACE ALLOWING FOR RECREATION, CONGREGATION, ACCESS AND TRANSITION THAT EXPRESSES A UNIQUE IDENTITY
- OPPORTUNITY FOR A SYMBIOTIC RELATIONSHIP WITH WESTFIELD BOORAGOON
- MANAGE SUBSTANTIAL LEVEL CHANGE BETWEEN STREET AND PEDESTRIAN COURTYARD SPACE
- PRIORITISE PEDESTRIAN ACCESS REQUIREMENTS ACROSS THE HIGH STREET

WESTFIELD BOORAGOON

KEY AREA D - COUNCIL / COMMUNITY

NOTE: PLANT SELECTION HAS BEEN MADE WITH REFERENCE TO THE CITY OF MELVILLE APPROVED TREE PLANTING LIST AND RELEVANT WIRELESS HILL PLANTING REFERENCES

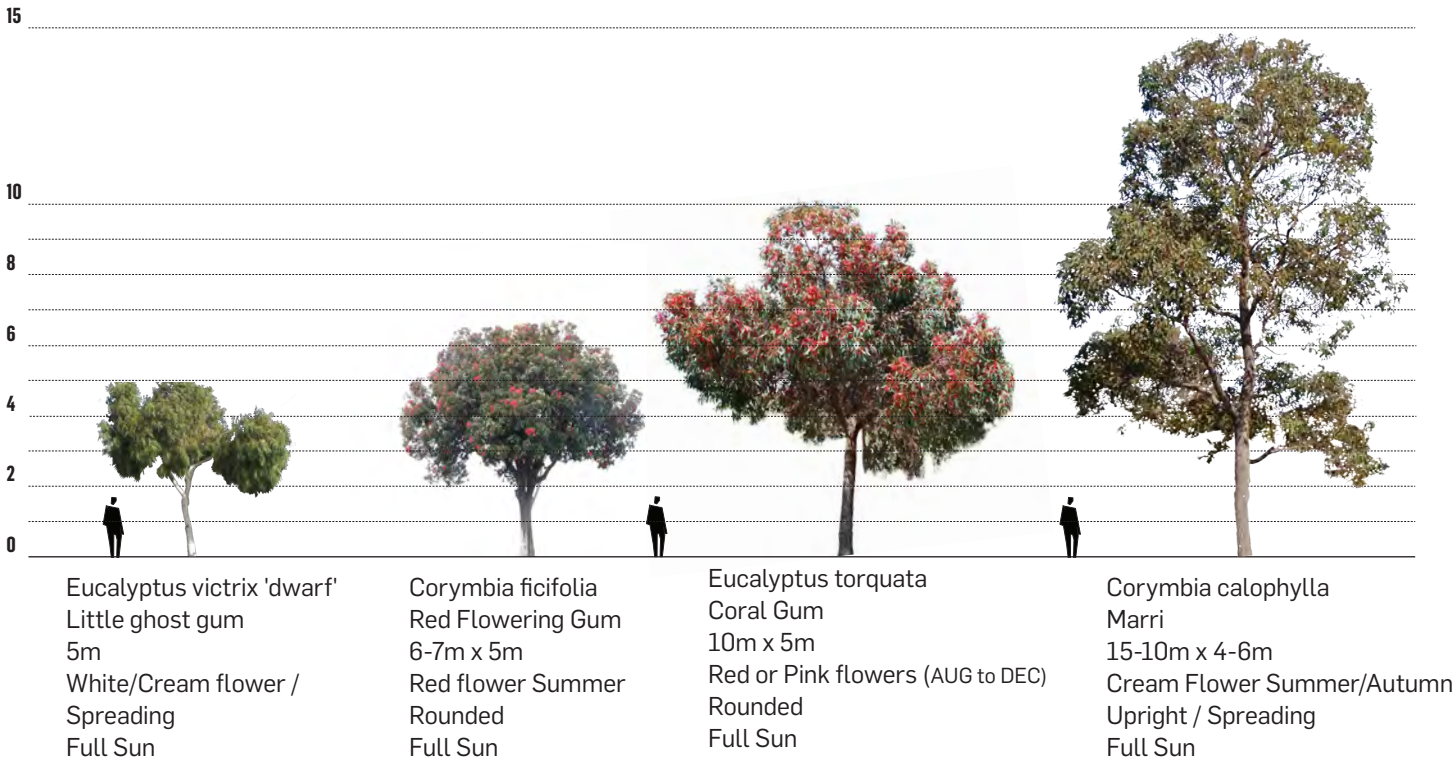

FEATURE TREES



Eucalyptus torquata



Corymbia Calophylla



Corymbia ficifolia



Eucalyptus victrix 'Ghost Gum'

FEATURE - 6 SEASON SPECIES



Hemiandra pungens



Banksia burdetti



Beaufortia elegans



Conospermum crasinervium



Scaevola crassifolia



Anigozanthos flavidus 'yellow'

SHRUB AND GROUNDCOVER SPECIES



Melaleuca huegelii



Grevillea preissii



Grevillea crithmifolia



Callistemon glauca
'Little Tom'



Anigozanthos sp.
'Bush Endeavour'



Lomandra sp. 'Nyalla'

WESTFIELD BOORAGOON
KEY AREA D - COUNCIL / COMMUNITY

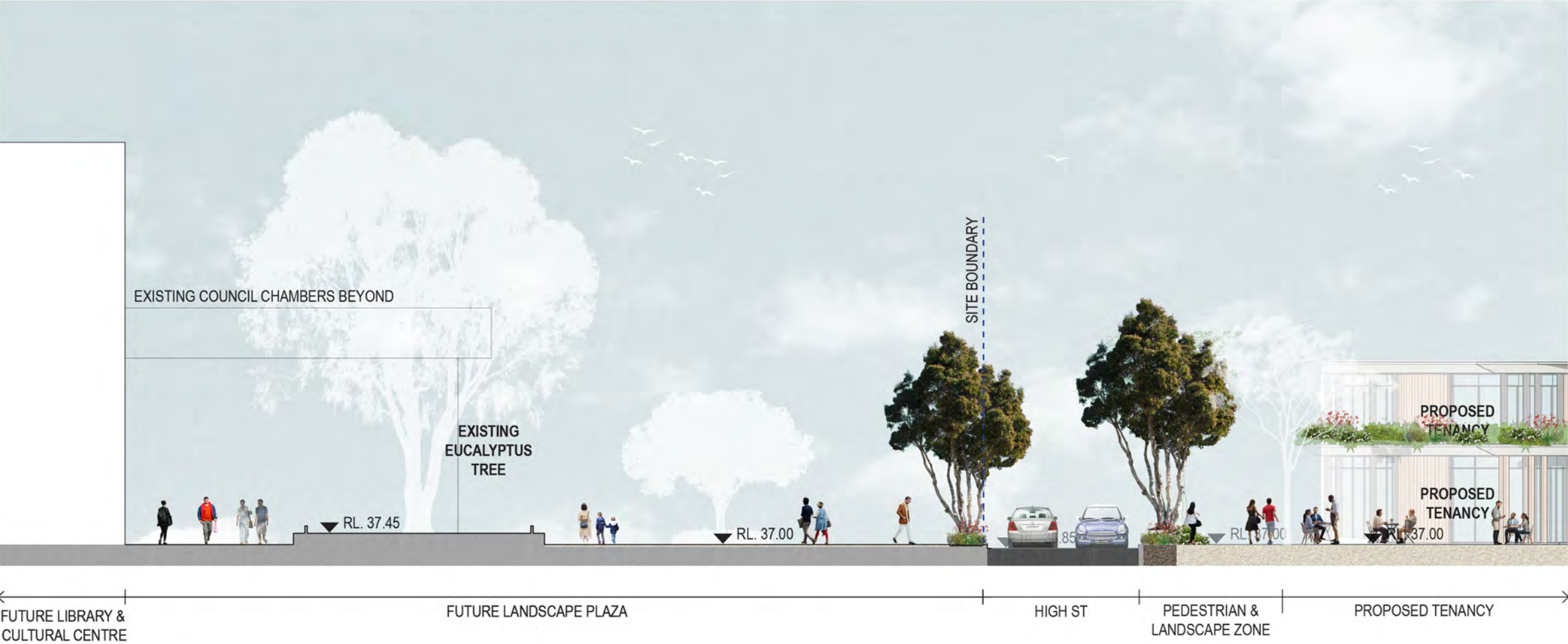
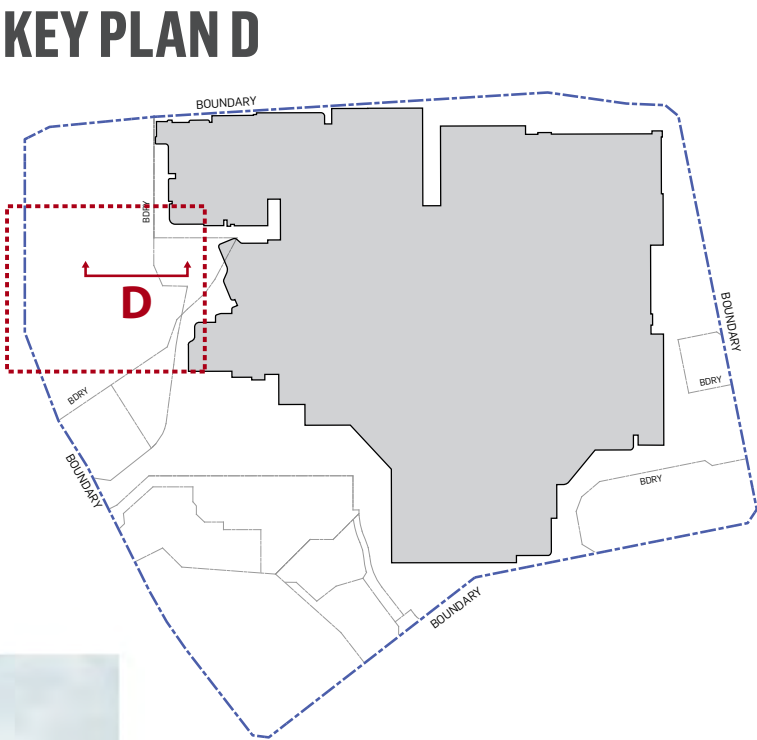

D-D_High Street East West Section - 1:200 @ A3

WESTFIELD BOORAGOON

KEY AREA E - BUS PORT ENTRY

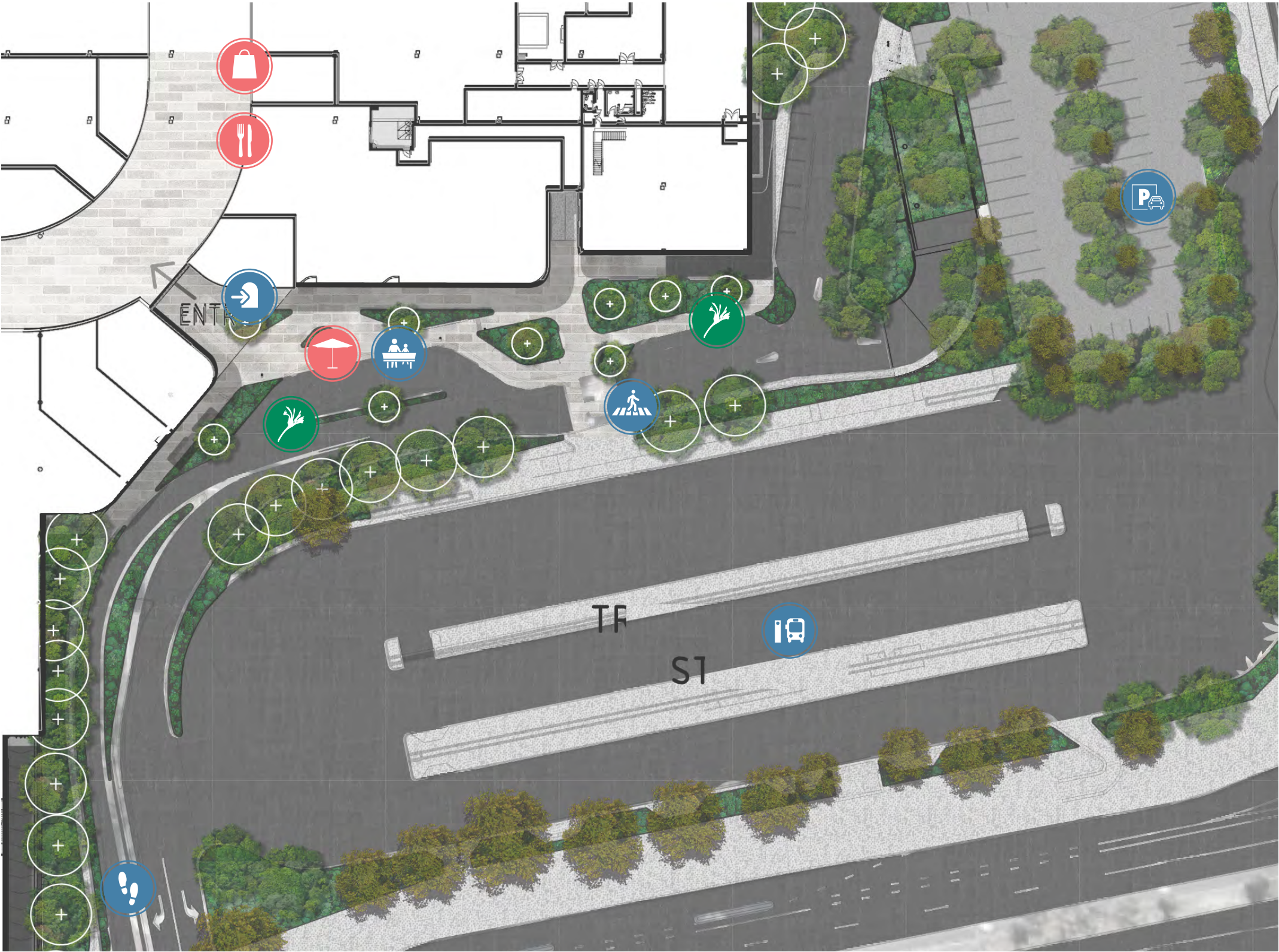

KEY PLAN E

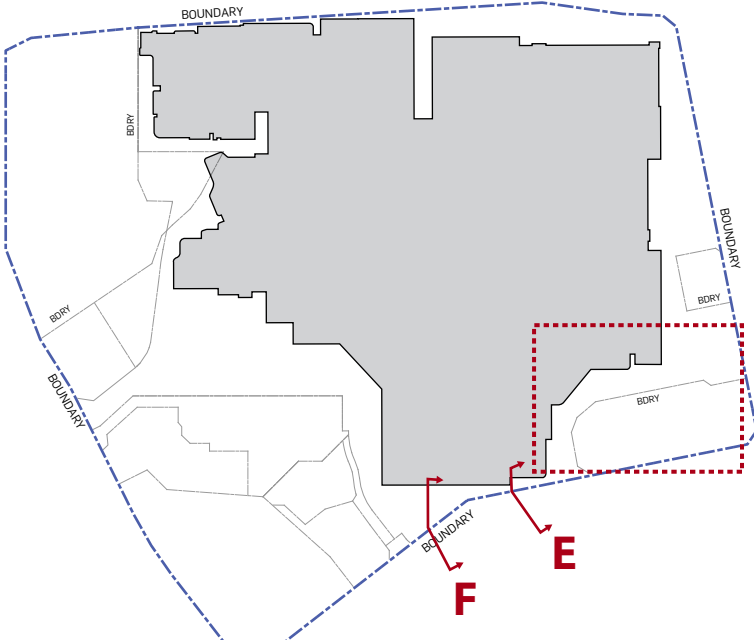

KEY ASPECTS:

- CLEAR AND DEFINED UNIVERSAL ENTRY TO WESTFIELD BOORAGOON
- PROVIDE ACCESS FROM PRIMARY ARRIVAL POINTS SUCH AS CAR PARKS AND BUS PORT
- ACCESS TO THE PEDESTRIAN CONCOURSE AND PATH NETWORK,
- FEATURES WAY-FINDING GATHERING AND ENTRY SIGNAGE OPPORTUNITIES FOR VISITORS
- PLANTING SCHEME TO ENHANCE THE ARRIVAL AESTHETIC
- PROVIDING UNIVERSAL ACCESS TO ALL CENTRE ENTRY POINTS

WESTFIELD BOORAGOON

KEY AREA E - BUS PORT ENTRY



NOTE: PLANT SELECTION HAS BEEN MADE WITH REFERENCE TO THE CITY OF MELVILLE APPROVED TREE PLANTING LIST AND RELEVANT WIRELESS HILL PLANTING REFERENCES

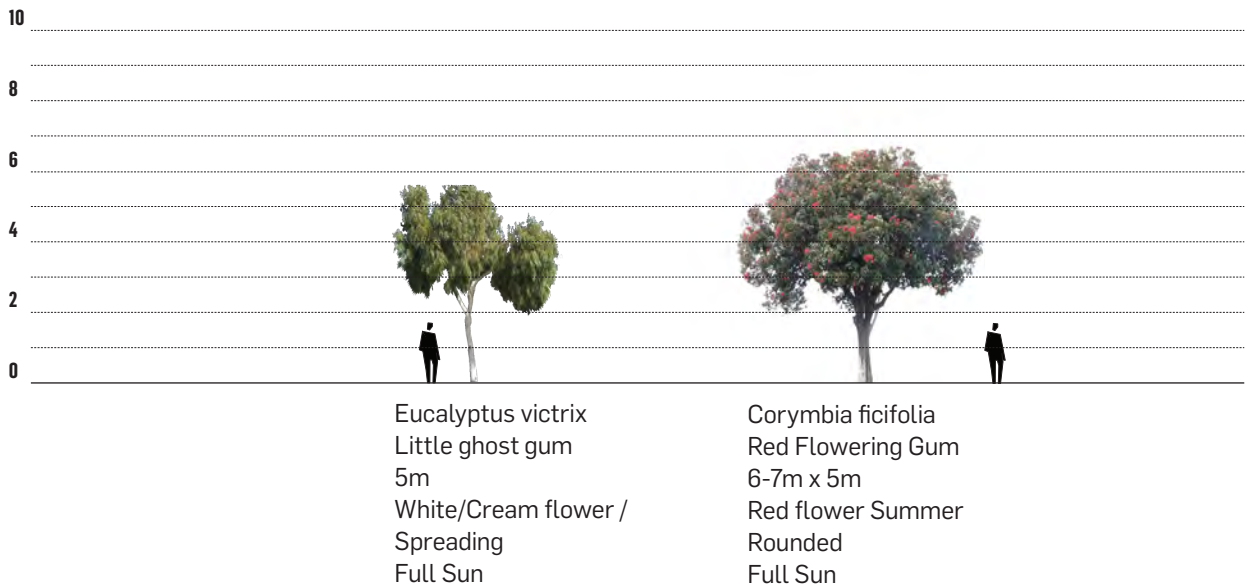

FEATURE TREES

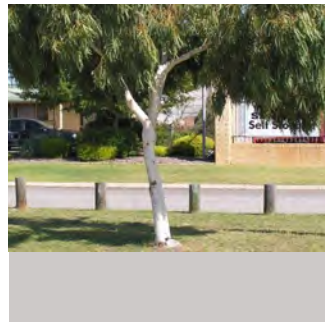

Eucalyptus victrix 'dwarf'



Corymbia ficifolia

FEATURE - 6 SEASON SPECIES



Acacia pulchella



Grevillea preissii



Beaufortia squarrosa



Regelia inops



Banksia dallanneyi



Eremaea pauciflora

SHRUB AND GROUNDCOVER SPECIES



Leuchophyta brownii



Conostylus candicans



Westringia fruticosa



Scaevola aemula



Patersonia occidentalis



Calothamnus quadrifidus

WESTFIELD BOORAGOON

KEY AREA E - BUS PORT ENTRY

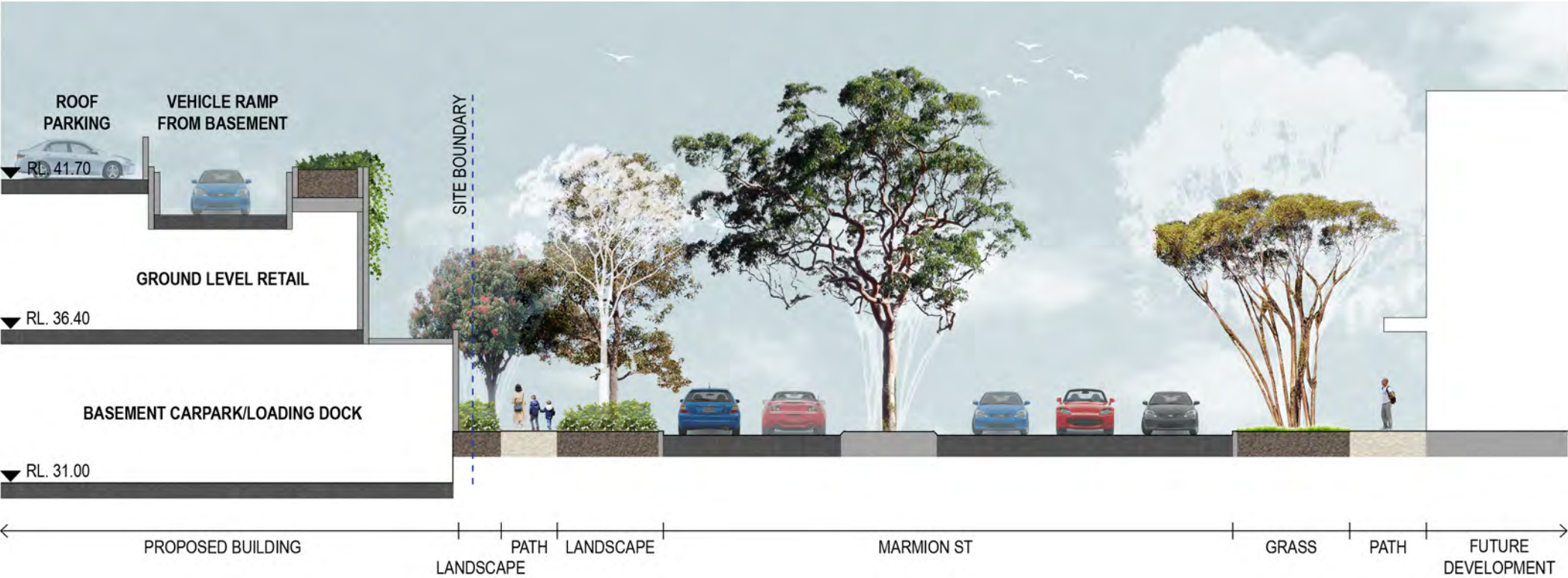

E-E _ MARMION STREET NORTH SOUTH SECTION - 1:200 @ A3

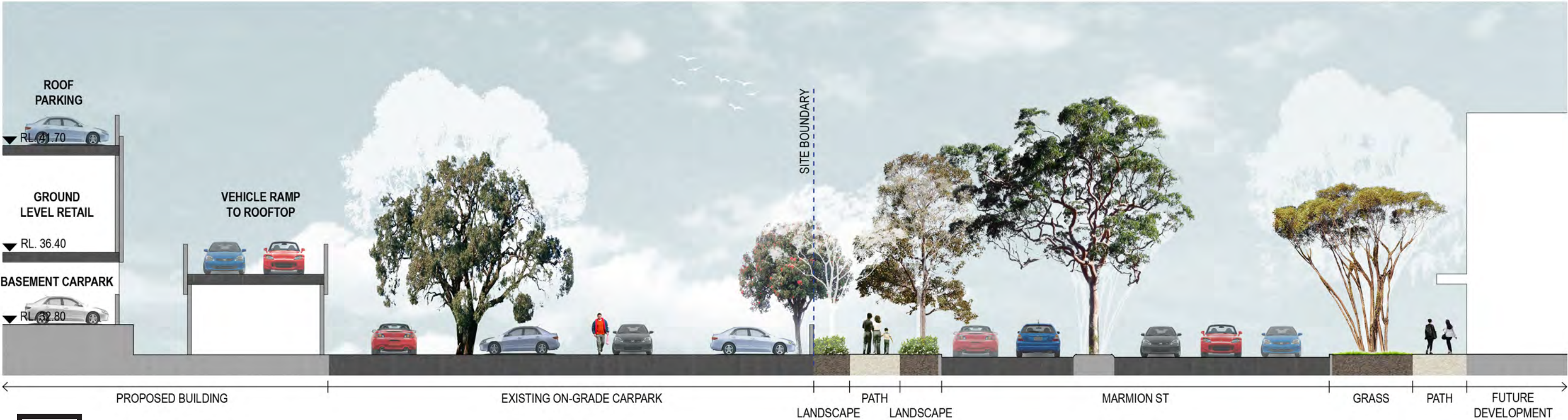

F-F _ MARMION STREET NORTH SOUTH SECTION - 1:200 @ A3

KEY PLAN E

