

No.	ISSUE/REVISION	DATE
0	ISSUED FOR APPROVAL	APRIL 23

THIS DRAWING TO BE READ
IN CONJUNCTION WITH THE STORAGE
TANK MANUFACTURER'S
PLANS AND SPECIFICATIONS

NOTES
ALL DIMENSIONS TO BE CHECKED BY
BUILDER PRIOR TO COMMENCEMENT
OF CONSTRUCTION

PROPOSED FLOOR AREAS
NEW SHED FLOOR AREA 50.0 m²

DEPARTMENT OF PLANNING, LANDS AND HERITAGE	
DATE	FILE
10-May-2023	21-50711-3

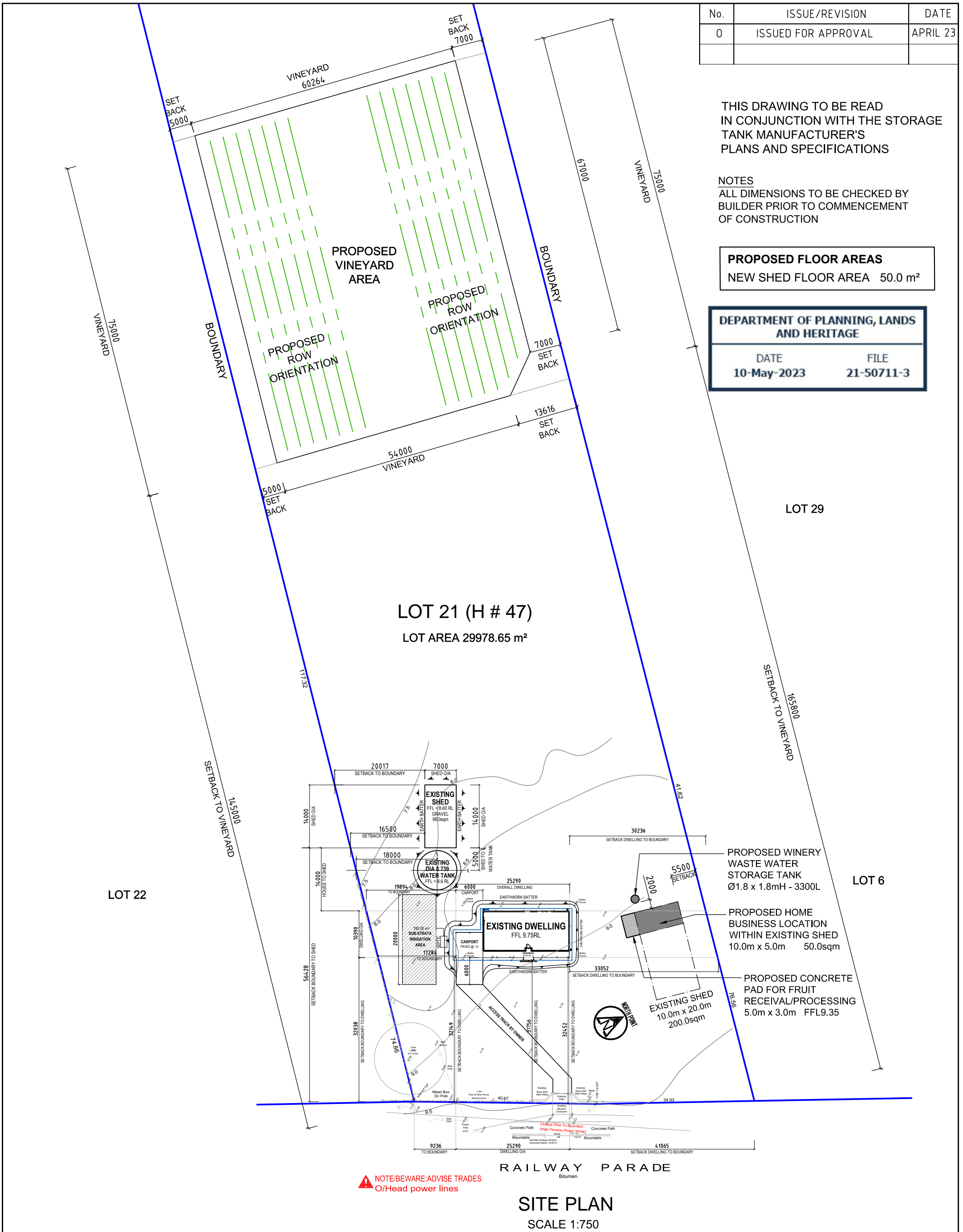

SITE PLAN
SCALE 1:750

LARKING DRAFTING SERVICES
BUILDING DESIGN & DRAFTING
GENERAL DRAFTING

32 Chapman Street
COLLIE WA 6225
Telephone:- Julia 0438 921 105
Email:- larkview@bigpond.net.au

COPYRIGHT RESERVED
This document is and remains the property of Larking Drafting Services and may not be copied in whole or part without the written consent of Larking Drafting Services.

CLIENT:
G BURGESS
47 RAILWAY PARADE BELHUS WA 6069

TITLE:
PROPOSED VINEYARD SITE PLAN 1:750

DRAWN: JPEL	DATE: APR 2023
SCALE: 1:750	SHEET No: 1 OF 2
JOB No: 2300-01	ISSUE O
FILE No: lkdraft\BURGESS.dwg	

COOLROOM NOTES - REFER TO NATIONAL CONSTRUCTION CODE 2019

G1.2 Refrigerated chambers, strong-rooms and vaults
Guide

(a) A refrigerated or cooling chamber, strongroom or vault which is of sufficient size for a person to enter must have:

- (i) a door which is capable of being opened by hand from inside without a key; and
- (ii) internal lighting controlled only by a switch which is located adjacent to the entrance doorway inside the chamber, strongroom or vault; and
- (iii) an indicator lamp positioned outside the chamber, strongroom or vault which is illuminated when the Interior lights required by (a)(ii) are switched on; and
- (iv) an alarm that is:
 - (A) located outside but controllable only from within the chamber, strongroom or vault; and
 - (B) able to achieve a sound pressure level outside the chamber, strongroom or vault of 90 dB when measured 3 m from the sounding device.

(b) A door required by (a)(i) in a refrigerated or cooling chamber must have a doorway with a clear width of not less than 600 mm and a clear height not less than 1.5 m.

No.	ISSUE/REVISION	DATE
0	Issued for approval	APRIL 2023

THIS DRAWING TO BE READ IN CONJUNCTION WITH THE STORAGE TANK MANUFACTURER'S PLAN AND SPECIFICATIONS.

ALL BUILDING WORK TO COMPLY WITH THE NATIONAL CONSTRUCTION CODE 2019

NOTES
ALL DIMENSIONS TO BE CHECKED BY BUILDER PRIOR TO COMMENCEMENT OF CONSTRUCTION

PROPOSED FLOOR AREAS
FLOOR AREA WITHIN EXISTING SHED 50.0m²

DEPARTMENT OF PLANNING, LANDS AND HERITAGE	
DATE	FILE
10-May-2023	21-50711-3

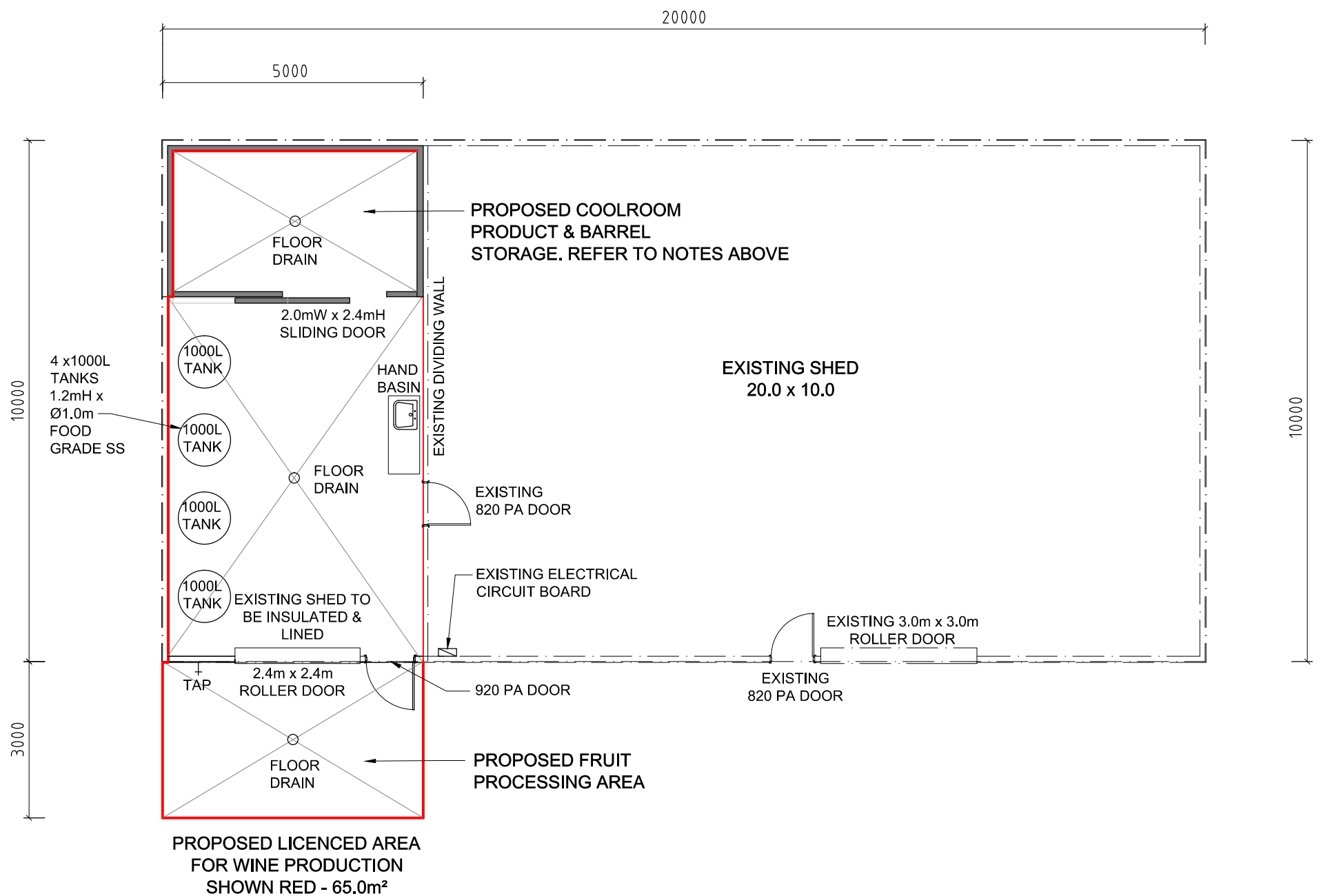

FLOOR PLAN INSIDE EXISTING SHED

SCALE 1:100

LARKING DRAFTING SERVICES

BUILDING DESIGN & DRAFTING
GENERAL DRAFTING

32 Chapman Street
COLLIE WA 6225
Telephone:- Julia 0438 921 105
Email:- larkview@bigpond.net.au

© COPYRIGHT RESERVED
This document is and remains the property of Larking Drafting Services and may not be copied in whole or part without the written consent of Larking Drafting Services.

CLIENT:

G BURGESS

47 RAILWAY PARADE BELHUS WA 6069

TITLE:

WINE PRODUCTION AREA FLOOR PLAN

DRAWN:
JPEL

SCALE:
1:100

JOB No:

2300-02

FILE No:

lkdraft\BURGESS.dwg

DATE:
APR 2023

SHEET No:
2 OF 2

ISSUE
0